



Lancaster Gate, W2



Lancaster Gate, W2

This fourth-floor residence in the prestigious Lancaster Gate W2, offers an expansive and thoughtfully designed layout, boasting approximately 3,196 square feet (296.9 square metres) of living space. The property manages to marry the grandeur of classical proportions with a modern sense of openness, making it both luxurious and liveable.

Entering the apartment, you are greeted by a generous hallway that sets the tone with its sense of spaciousness, ideal for creating an elegant entrance.

The heart of the home is undoubtedly the sprawling double reception and dining room, where natural light pours in through a line of windows, inviting views directly into Hyde Park. This room is not only vast in size but also versatile, perfect for entertaining on a grand scale, or sectioning off for more intimate gatherings. Adjacent, a more intimate reception room offers additional flexibility — ideal for a family room or private study.

The kitchen, while compact compared to the reception areas, is perfectly functional, with ample workspace and a layout that will appeal to the modern chef.

The bedroom wing feels markedly private, away from the entertaining spaces. The principal bedroom is a haven of tranquillity, featuring an en-suite bathroom, ensuring privacy and luxury. Three further bedrooms are dotted along this wing: the largest of which could easily serve as an additional primary room if required. Each of these bedrooms benefits from generous proportions and access to shared or en-suite bathroom facilities, making the layout ideal for family living or accommodating guests.

This is a home that perfectly balances opulence with functionality, offering large communal spaces for entertaining, while ensuring private bedrooms are kept secluded for quiet retreats. A true gem in one of London's most sought-after postcodes.



Lancaster Gate, W2

Approximate Area = 3196 sq ft / 296.9 sq m
Including Limited Use Area (81 sq ft / 7.5 sq m)

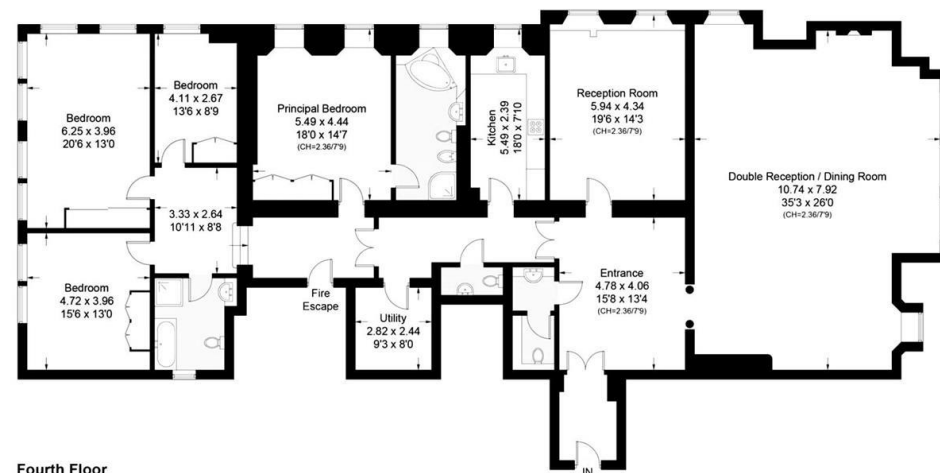

Fourth Floor

This plan is for layout guidance only. Not drawn to scale unless stated. Windows and door openings are approximate. Whilst every care is taken in the preparation of this plan, please check all dimensions, shapes and compass bearings before making any decisions reliant upon them. (ID810430)

020 7096 9476

contact@landstones.co.uk

Whilst every effort is made to ensure the accuracy of these details, it should be noted that the measurements are approximate only. Floorplans are for representation purposes only and prepared according to the RICS Code of Measuring Practice by our floorplan provider. Therefore, the layout of doors, windows and rooms are approximate and should be regarded as such by any prospective purchaser. Any internal photographs are intended as a guide only and it should not be assumed that any of the furniture/fittings are included in any sale. Where shown, details of lease, ground rent and service charge are provided by the vendor and their accuracy cannot be guaranteed, as the information may not have been verified and further checks should be made either through your solicitor/conveyance. Where appliances, including central heating, are mentioned, it cannot be assumed that they are in working order, as they have not been tested. Please also note that wiring, plumbing and drains have not been checked.