



Eaton Place, SW1X

# Eaton Place, SW1X

This property is spread across several levels, offering a generous 2,713 square feet (252 square metres) of living space.

Upon entering, you are greeted by a dedicated storage area, perfect for stowing away everyday items while keeping the main living spaces clutter-free. The entrance opens into a formal living room, whose proportions are perfect for hosting intimate gatherings. Adjoining this is the kitchen, compact yet efficient. The adjacent drawing room is a standout feature, spanning the width of the property. With its large windows and high ceilings, this space is flooded with natural light, creating an inviting atmosphere for both entertaining and relaxation.

Moving upwards, the third floor is dedicated to the principal bedroom, which is nothing short of grand. Spacious and well-appointed, complemented by an en-suite bathroom. A dedicated office space is also situated on this floor, perfect for working from home, while a secondary bedroom serving not only as a guest bedroom but also as an ideal space for a television or media room.

The top floor accommodates two generously sized bedrooms ideal for children, guests, or even converting into a home gym. A smaller bedroom and a dedicated dressing room round out this floor, making it perfect for a growing family or those who frequently host visitors.

Eaton Place SW1, is a part of London's esteemed Belgravia, a neighbourhood that has long been synonymous with elegance, grandeur, and the capital's elite. Built in the early 19th century, Eaton Place and its surrounding streets were commissioned by the Grosvenor family, whose vast landholdings shaped much of modern Mayfair and Belgravia.

Council Tax Band: H (Westminster)  
Tenure: Share of Freehold

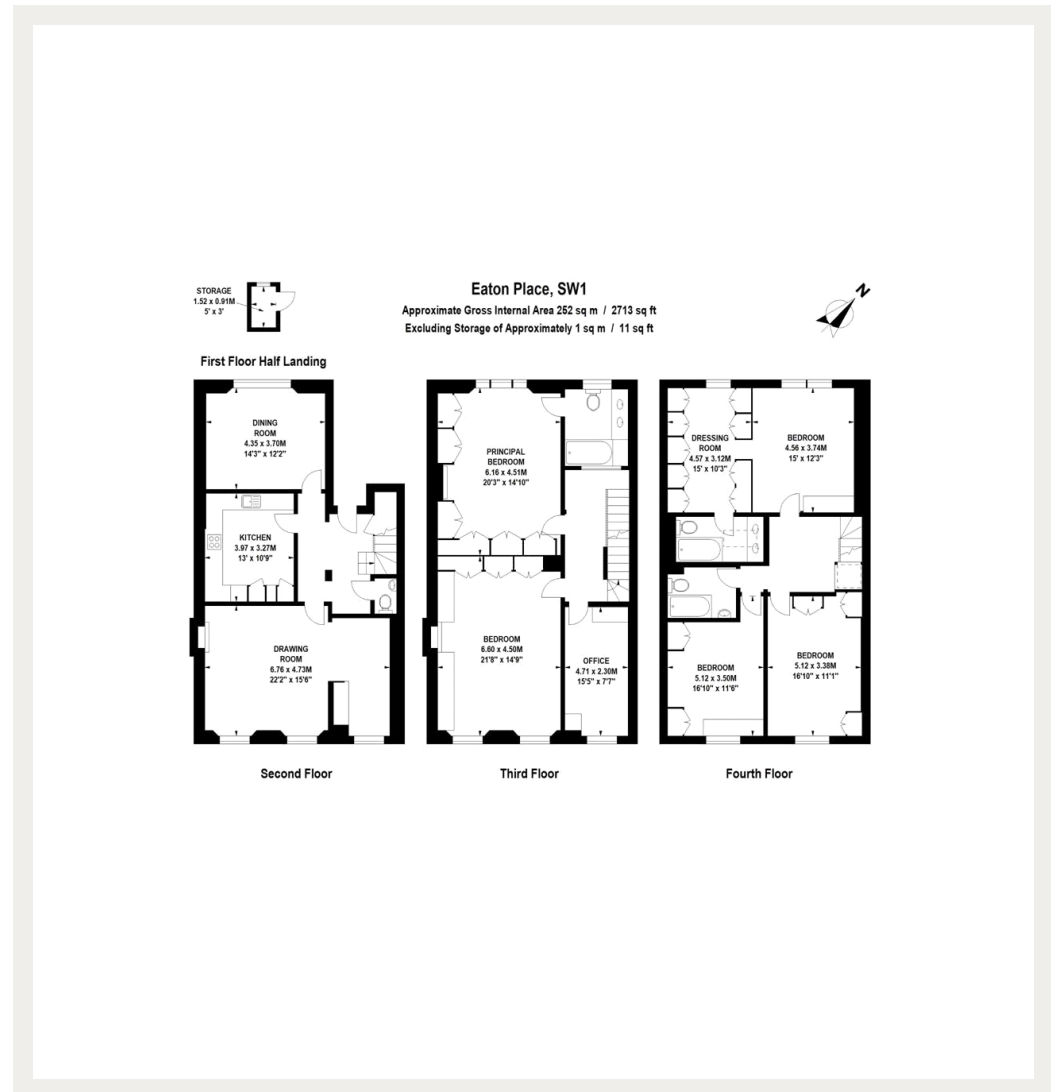

020 7096 9476

contact@landstones.co.uk

Whilst every effort is made to ensure the accuracy of these details, it should be noted that the measurements are approximate only. Floorplans are for representation purposes only and prepared according to the RICS Code of Measuring Practice by our floorplan provider. Therefore, the layout of doors, windows and rooms are approximate and should be regarded as such by any prospective purchaser. Any internal photographs are intended as a guide only and it should not be assumed that any of the furniture/fittings are included in any sale. Where shown, details of lease, ground rent and service charge are provided by the vendor and their accuracy cannot be guaranteed, as the information may not have been verified and further checks should be made either through your solicitor/conveyance. Where appliances, including central heating, are mentioned, it cannot be assumed that they are in working order, as they have not been tested. Please also note that wiring, plumbing and drains have not been checked.