



Elm Park Gardens, SW10

Elm Park Gardens, SW10

A beautiful and bright one bedroom apartment set on the fifth floor (with lift) within this well maintained purpose built building benefiting from direct access to the attractive private communal gardens.

Situated in the heart of Chelsea, Elm Park Gardens is only moments away from all of the amenities of the Kings Road and Fulham Road which both offer a wide variety of shops, restaurants and cafes. The nearest underground stations are South Kensington and Gloucester Road.

Council Tax Band: F
Deposit: £2,375

Top Floor Flat, Heating Included, Communal Garden,
Basement Storage Room

Asking price: £475



Fifth Floor

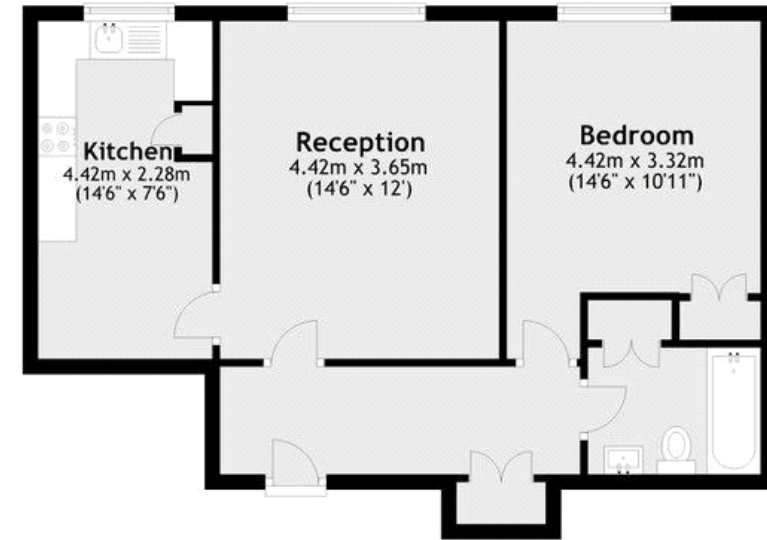

Total area: approx. 53.6 sq. metres (577.2 sq. feet)

020 7096 9476

contact@landstones.co.uk

Whilst every effort is made to ensure the accuracy of these details, it should be noted that the measurements are approximate only. Floorplans are for representation purposes only and prepared according to the RICS Code of Measuring Practice by our floorplan provider. Therefore, the layout of doors, windows and rooms are approximate and should be regarded as such by any prospective tenant.