



Iverna Gardens, W8

Iverna Gardens, W8

Currently going under a complete refurbishment, a stunning one bedroom apartment in this period building with a private terrace at the front.

Iverna Gardens is perfectly positioned in the heart of Kensington close to the many lively bars and restaurants. Hyde Park and Holland Park are also a short walk away.

Council Tax Band: E
Deposit: £3,175

Brand New Refurbished, Private Terrace, Wooden Floors, Pet Friendly

Asking price: £635



Iverna Gardens, W8 6TP

Approx. Gross Internal Area 450 Sq Ft - 41.81 Sq M

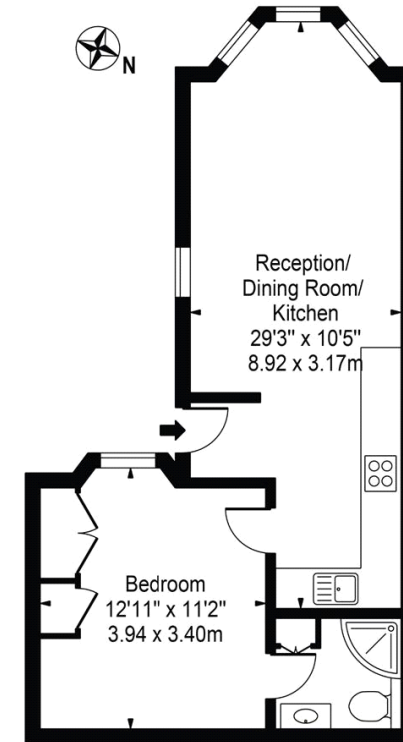

Lower Ground Floor

For Illustration Purposes Only - Not To Scale

This floor plan should be used as a general outline for guidance only and does not constitute in whole or in part an offer or contract. Any intending purchaser or lessee should satisfy themselves by inspection, searches, enquiries and full survey as to the correctness of each statement. Any areas, measurements or distances quoted are approximate and should not be used to value a property or be the basis of any sale or let.

020 7096 9476

contact@landstones.co.uk

Whilst every effort is made to ensure the accuracy of these details, it should be noted that the measurements are approximate only. Floorplans are for representation purposes only and prepared according to the RICS Code of Measuring Practice by our floorplan provider. Therefore, the layout of doors, windows and rooms are approximate and should be regarded as such by any prospective tenant.