



Old Brompton Road, SW7

Old Brompton Road, SW7

A fantastic split level two bedroom maisonette, set over the first and second floors. The apartment itself benefits from a very large rear terrace and attractive southerly views out towards Onslow Gardens opposite.

Located in the heart of South Kensington, moments away from the many shops, bars and restaurants of Old Brompton Road. The nearest underground station is South Kensington.

Deposit: £4,625

Two Bedrooms, Two Bathrooms, Wooden Floors, Private Rooftop

Asking price: £925 pw

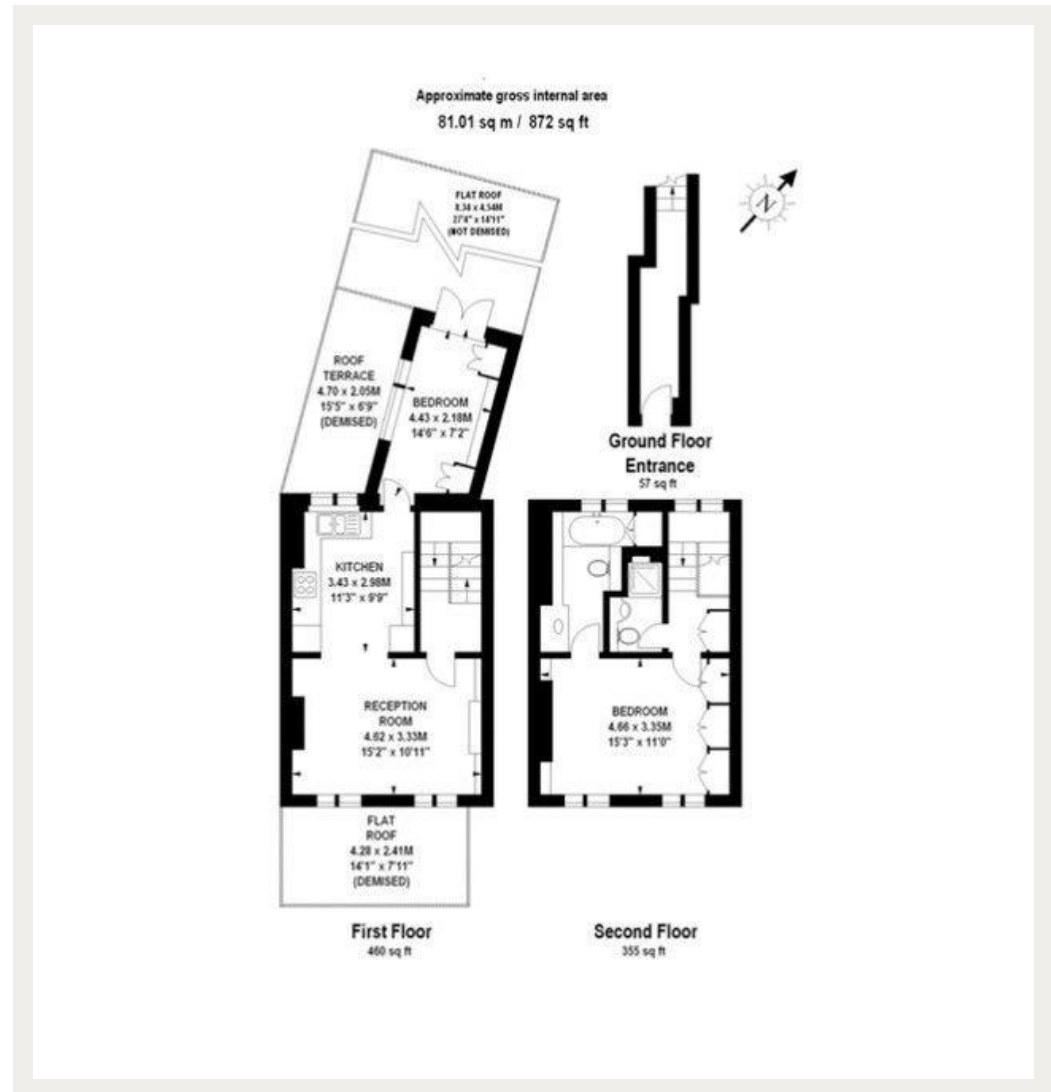

020 7096 9476

contact@landstones.co.uk

Whilst every effort is made to ensure the accuracy of these details, it should be noted that the measurements are approximate only. Floorplans are for representation purposes only and prepared according to the RICS Code of Measuring Practice by our floorplan provider. Therefore, the layout of doors, windows and rooms are approximate and should be regarded as such by any prospective tenant.