



Earl's Court Square, SW5

Earl's Court Square, SW5

A spacious three bedroom lateral apartment arranged over the garden level of this well-maintained Mansion block.

Wetherby Mansions is a popular red brick 1890's mansion block discretely positioned to the southern side of Earl's Court Square only a five minutes' walk from Earl's Court Station offering superb transport links both into and out of Central London. There are also a great variety of shops and restaurants on the doorstep.

Council Tax Band: G
Deposit: £7,200

Access To Communal Gardens, Private Terrace

Asking price: £1,200

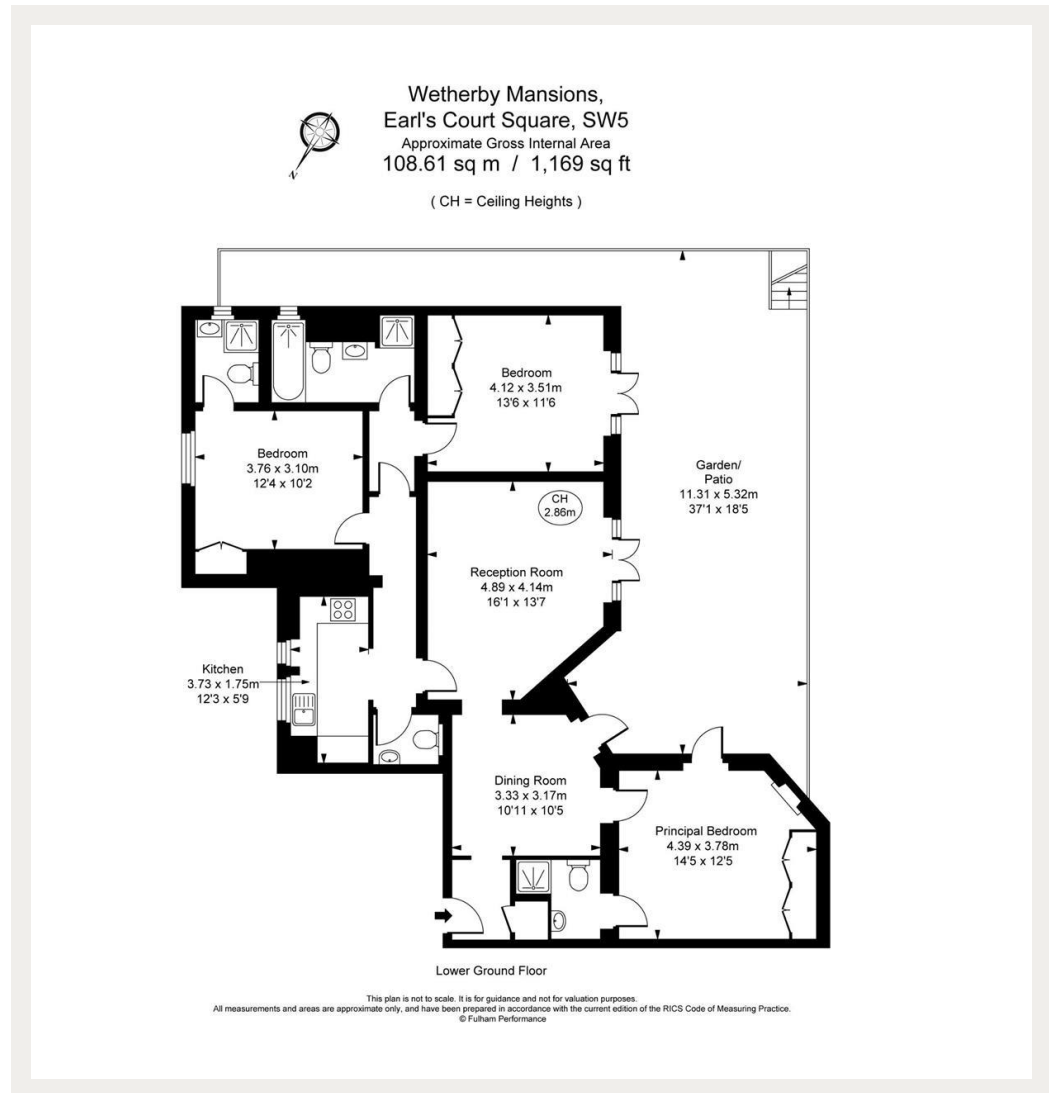

020 7096 9476

contact@landstones.co.uk

Whilst every effort is made to ensure the accuracy of these details, it should be noted that the measurements are approximate only. Floorplans are for representation purposes only and prepared according to the RICS Code of Measuring Practice by our floorplan provider. Therefore, the layout of doors, windows and rooms are approximate and should be regarded as such by any prospective tenant.