



Cromwell Road, SW7

Cromwell Road, SW7

A spacious three bedroom lateral apartment set over the first floor within this period building located moments away from Gloucester Road station.

The property is within walking distance from Gloucester Road tube station, as well as all the shops, restaurants and amenities of South Kensington. Hyde Park is also a short walk away.

Deposit: £7,200

Asking price: £1,200

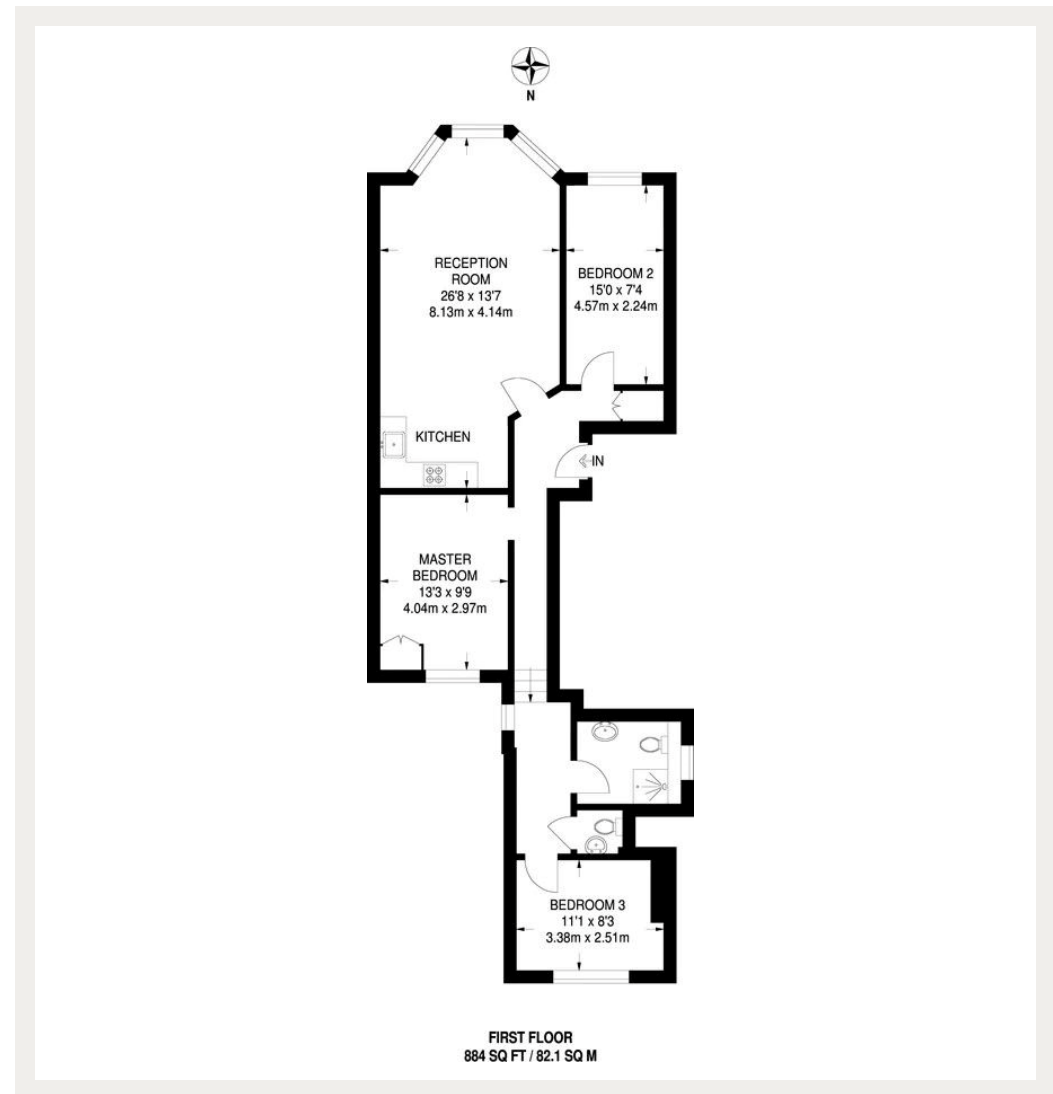

020 7096 9476

contact@landstones.co.uk

Whilst every effort is made to ensure the accuracy of these details, it should be noted that the measurements are approximate only. Floorplans are for representation purposes only and prepared according to the RICS Code of Measuring Practice by our floorplan provider. Therefore, the layout of doors, windows and rooms are approximate and should be regarded as such by any prospective tenant.