



Ladbroke Gardens, W11

# Ladbroke Gardens, W11

Brand new refurbished three bedroom apartment with direct access to the beautifully maintained communal gardens to the rear.

Ladbroke Gardens is one of the premier streets in Notting Hill. Ideally located for a walk to Notting Hill Gate underground for the District, Central and Circle Lines. The popular boutiques and restaurants on Westbourne Grove are nearby as is the world famous Portobello Road. The beautiful open spaces of Holland Park, Kensington Gardens and Hyde Park are also within easy reach.

Council Tax Band: G  
Deposit: £13,500

**Asking price: £2,250**

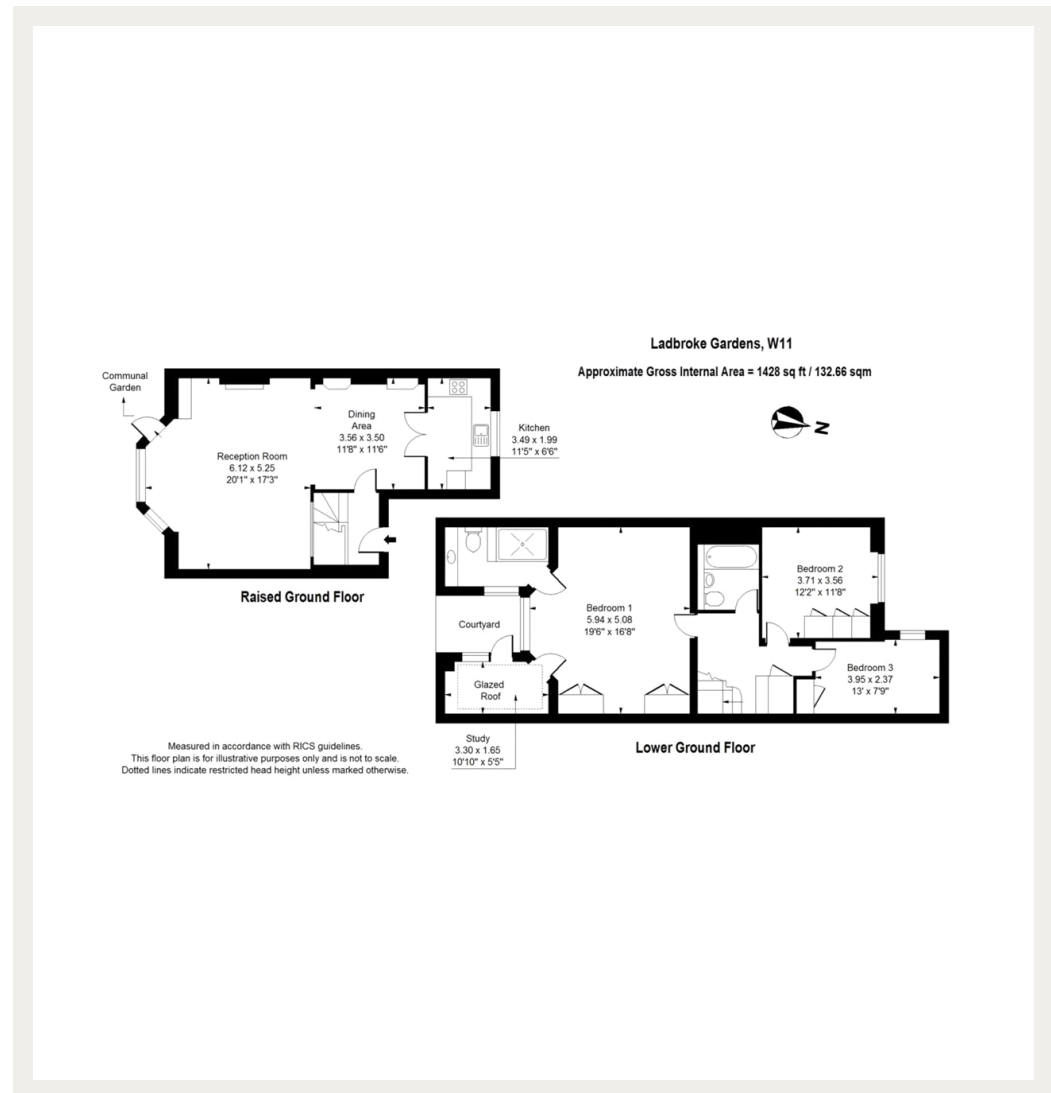

020 7096 9476

contact@landstones.co.uk

Whilst every effort is made to ensure the accuracy of these details, it should be noted that the measurements are approximate only. Floorplans are for representation purposes only and prepared according to the RICS Code of Measuring Practice by our floorplan provider. Therefore, the layout of doors, windows and rooms are approximate and should be regarded as such by any prospective tenant.