



Edith Grove, SW10

Edith Grove, SW10

A modern three bedroom apartment set over the ground floor of this attractive mansion block in Chelsea.

Located moments away from the many shops, bars and restaurants of Kings Road and Fulham Road.

Deposit: £5,820

Garden details: Private Garden

Garden, High Ceilings & Wood Floors

Asking price: £970 pw

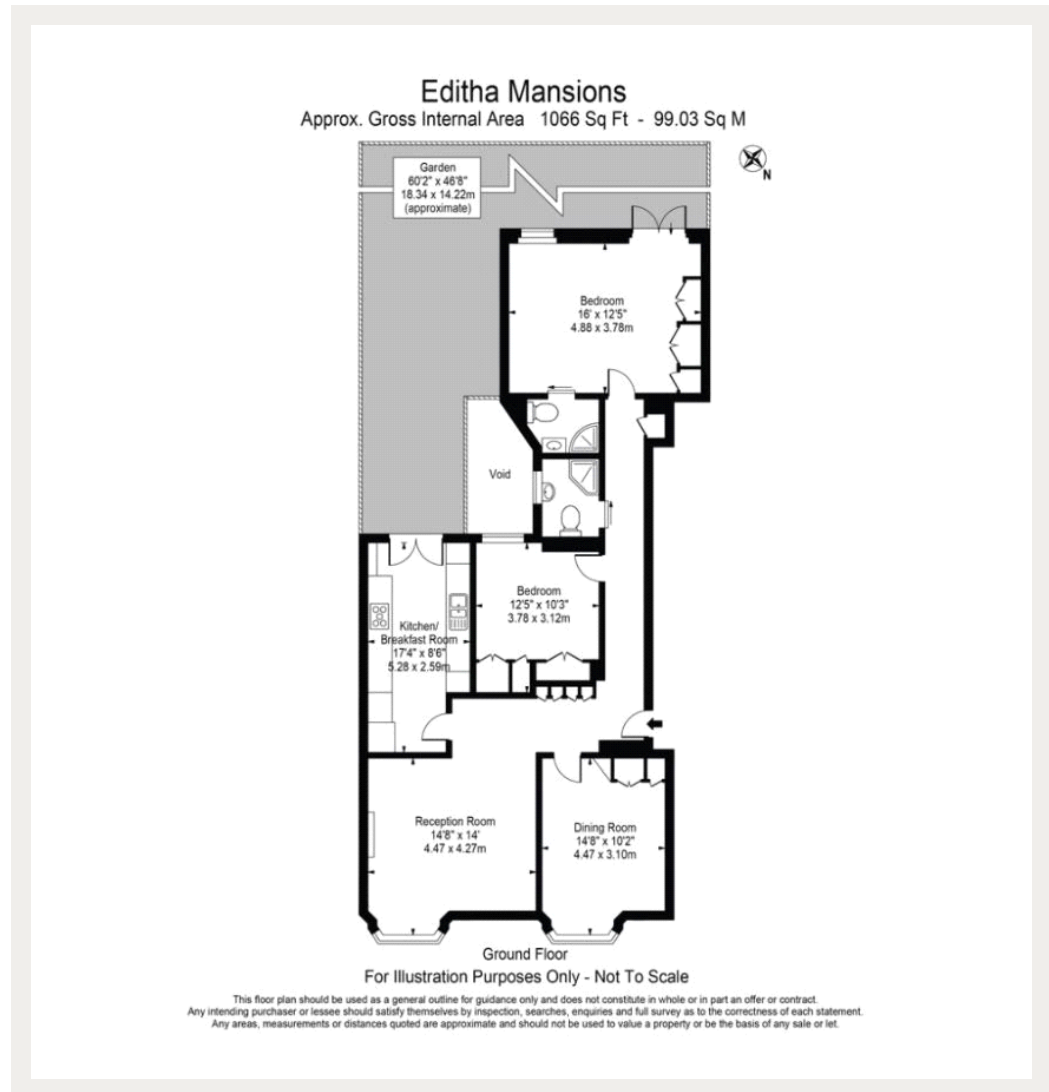

020 7096 9476

contact@landstones.co.uk

Whilst every effort is made to ensure the accuracy of these details, it should be noted that the measurements are approximate only. Floorplans are for representation purposes only and prepared according to the RICS Code of Measuring Practice by our floorplan provider. Therefore, the layout of doors, windows and rooms are approximate and should be regarded as such by any prospective tenant.