



Onslow Crescent, SW7

# Onslow Crescent, SW7

This brand newly refurbished three-bedroom flat in the heart of South Kensington offers the perfect blend of modern living and classic charm. The apartment features a spacious living room with abundant natural light, a designated dining area, and a fully equipped bespoke kitchen.

The location is highly sought-after, situated in one of the most prestigious and attractive areas in London, South Kensington is known for its beautiful Victorian architecture, tree-lined streets and its proximity to some of London's most famous cultural landmarks, such as the Victoria and Albert Museum, the Natural History Museum, and the Science Museum. The area is also home to some of the most beautiful parks in London, including Hyde Park and Kensington Gardens, perfect for a morning run or an afternoon picnic.

Council Tax Band: G  
Deposit: £12,000

24/7 Porter, Brand New Refurbished, Heating & Hot Water Included

**Asking price:** £2,000 pw

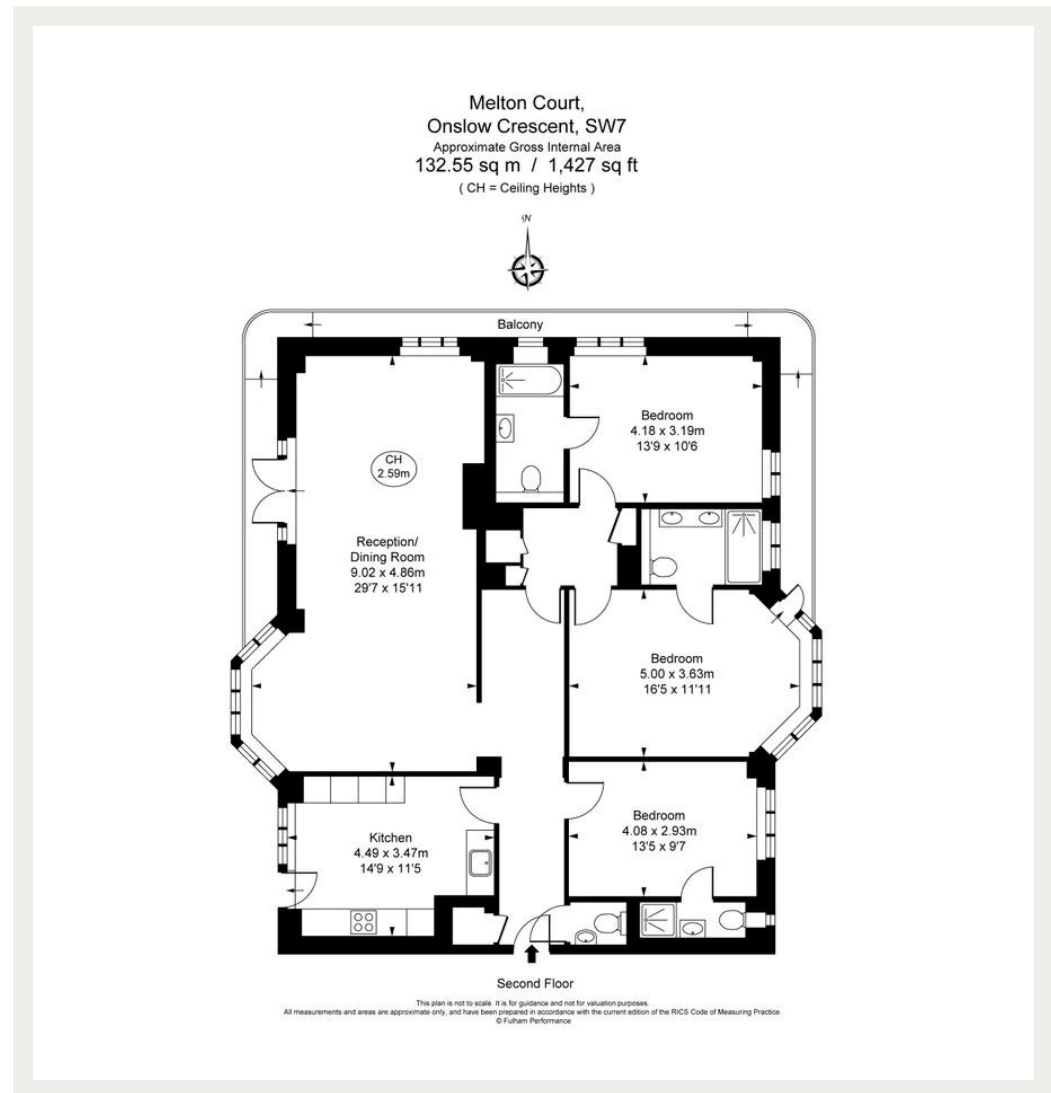

Whilst every effort is made to ensure the accuracy of these details, it should be noted that the measurements are approximate only. Floorplans are for representation purposes only and prepared according to the RICS Code of Measuring Practice by our floorplan provider. Therefore, the layout of doors, windows and rooms are approximate and should be regarded as such by any prospective tenant.

020 7096 9476

contact@landstones.co.uk