



Palace Gardens Terrace, W8



Palace Gardens Terrace, W8

This stunning light bright 2-bedroom garden flat sits on one of Kensington's most picturesque and sort after addresses, Palace Gardens Terrace. The two-bedroom residence offers an elegant living space with high ceilings that create a bright and spacious atmosphere with premium finishes throughout and convenient access to amenities, this apartment presents a luxurious and comfortable lifestyle.

As you enter the apartment the large reception room open up before you. Light and bright with many period features remaining this room gives a cosy but styling living experience. Moving through the property the modern kitchen boasts high-end appliances, while the bedrooms offer peaceful sanctuaries, with the large master bedroom to the rear and the second bedroom a perfect home office or guest bedroom.

Leading out from the kitchen the property has its own private rear garden, perfect for entertaining, BBQs or just a quiet spot to enjoy the green surroundings. This apartment presents an unparalleled opportunity for luxurious city living.

Palace Gardens Terrace is one of the most desirable streets in Kensington, moments away from the many shops, bars and restaurants of Notting Hill and Kensington. Hyde Park is also within walking distance. The nearest underground station is Notting Hill Gate.

Tenure: Leasehold

Newly Renovated, Period Building, Two Bathrooms, Wooden Floors

Asking price: £1,550,000

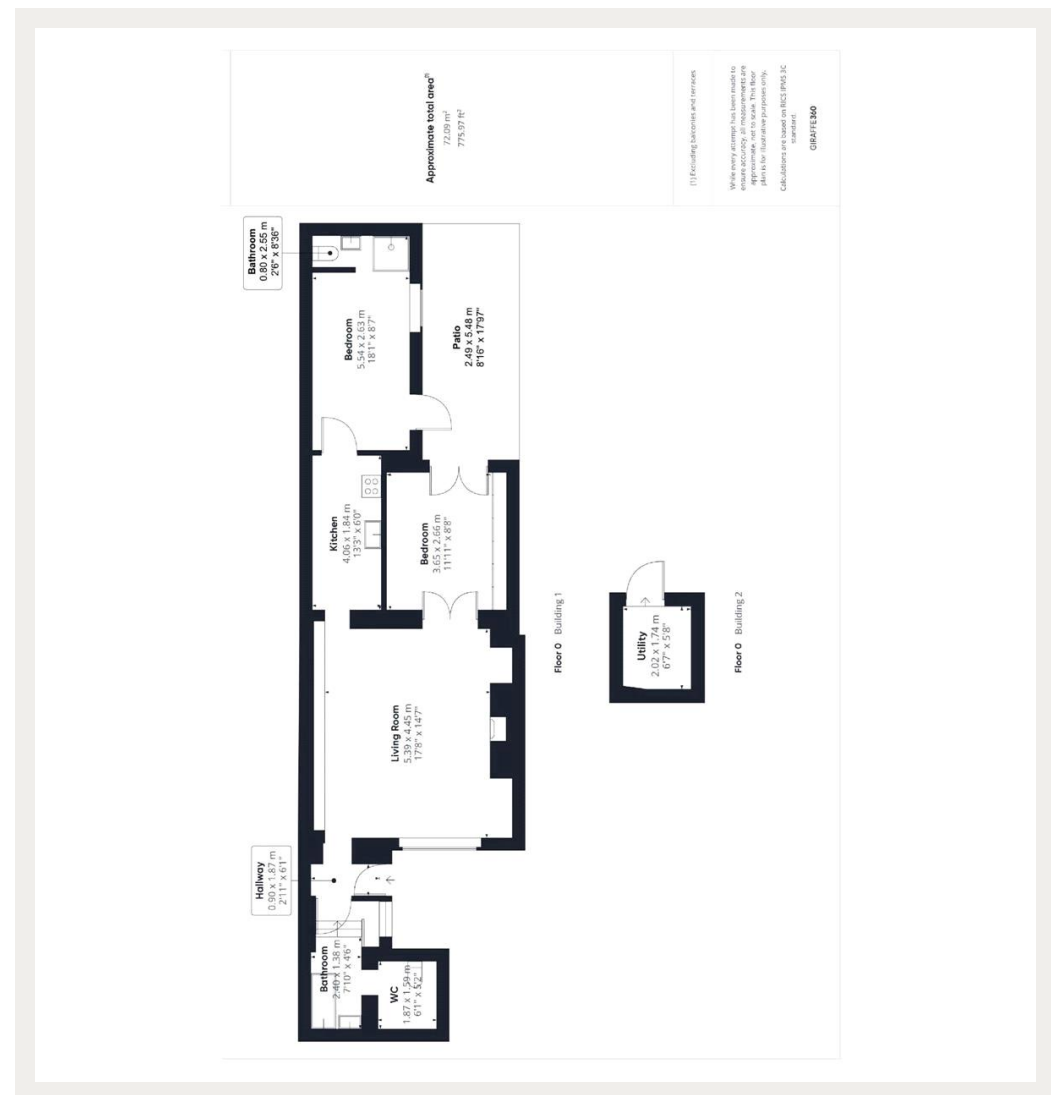

020 7096 9476

contact@landstones.co.uk

Whilst every effort is made to ensure the accuracy of these details, it should be noted that the measurements are approximate only. Floorplans are for representation purposes only and prepared according to the RICS Code of Measuring Practice by our floorplan provider. Therefore, the layout of doors, windows and rooms are approximate and should be regarded as such by any prospective purchaser. Any internal photographs are intended as a guide only and it should not be assumed that any of the furniture/fittings are included in any sale. Where shown, details of lease, ground rent and service charge are provided by the vendor and their accuracy cannot be guaranteed, as the information may not have been verified and further checks should be made either through your solicitor/conveyance. Where appliances, including central heating, are mentioned, it cannot be assumed that they are in working order, as they have not been tested. Please also note that wiring, plumbing and drains have not been checked.