



Wallingford Avenue, W10

Wallingford Avenue, W10

A beautifully finished semi-detached family home set in the heart of North Kensington.

Offered on a short-let basis, this architecturally designed and fully refurbished house is arranged over three levels, featuring an open-plan kitchen and reception room, three bathrooms, and a low-maintenance garden at the rear.

Wallingford Avenue is a charming, tree-lined street, conveniently located near local shops, boutiques, and well-regarded schools. Latimer Road underground station (Circle and Hammersmith & City lines) is just 0.4 miles away, with the fabulous amenities of Westfield, Notting Hill, Portobello Road, and Golborne Road also within easy reach.

Deposit: £15,000

Family House, Open Plan Kitchen, Architecturally Designed, Private Garden, All Bills Inclusive

Asking price: £3,462 pw

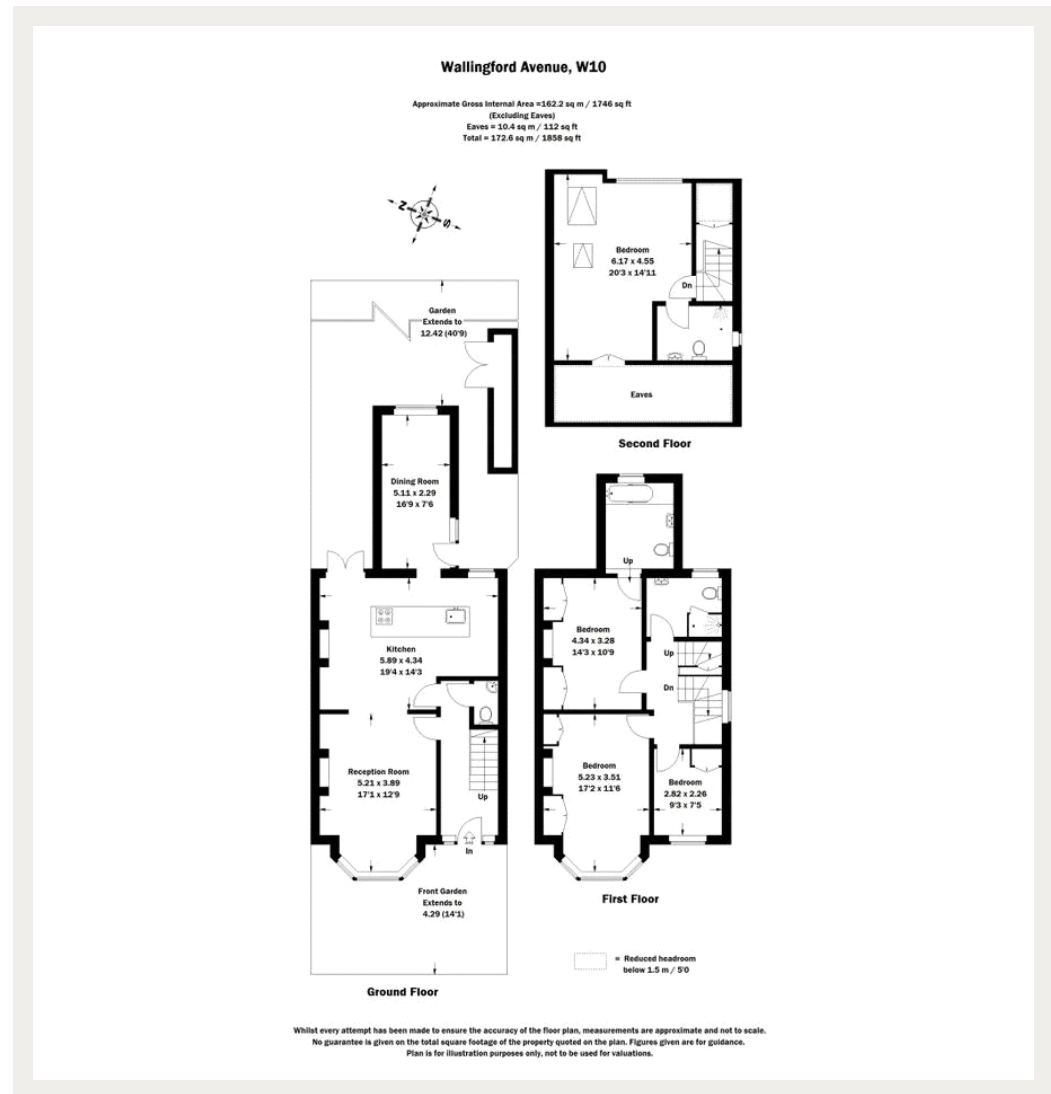

020 7096 9476

contact@landstones.co.uk