



Pembroke Road, W8

## Pembroke Road, W8

A bright and spacious three double bedroom apartment to rent in a well maintained portered block on Pembroke Road with lift and communal gardens. Hot water and heating are included in the rent.

Pembroke Road and is conveniently located for the many transport facilities, shops and parks in the area. Furthermore, there are excellent bars and restaurants close by including Kitchen W8, The Abingdon, Yashin and Dishoom to only name a few.

Council Tax Band: F  
Deposit: £6,900

Communal Garden, Heating & Hot Water Included , Lift Access, Porter

**Asking price:** £1,150 pw

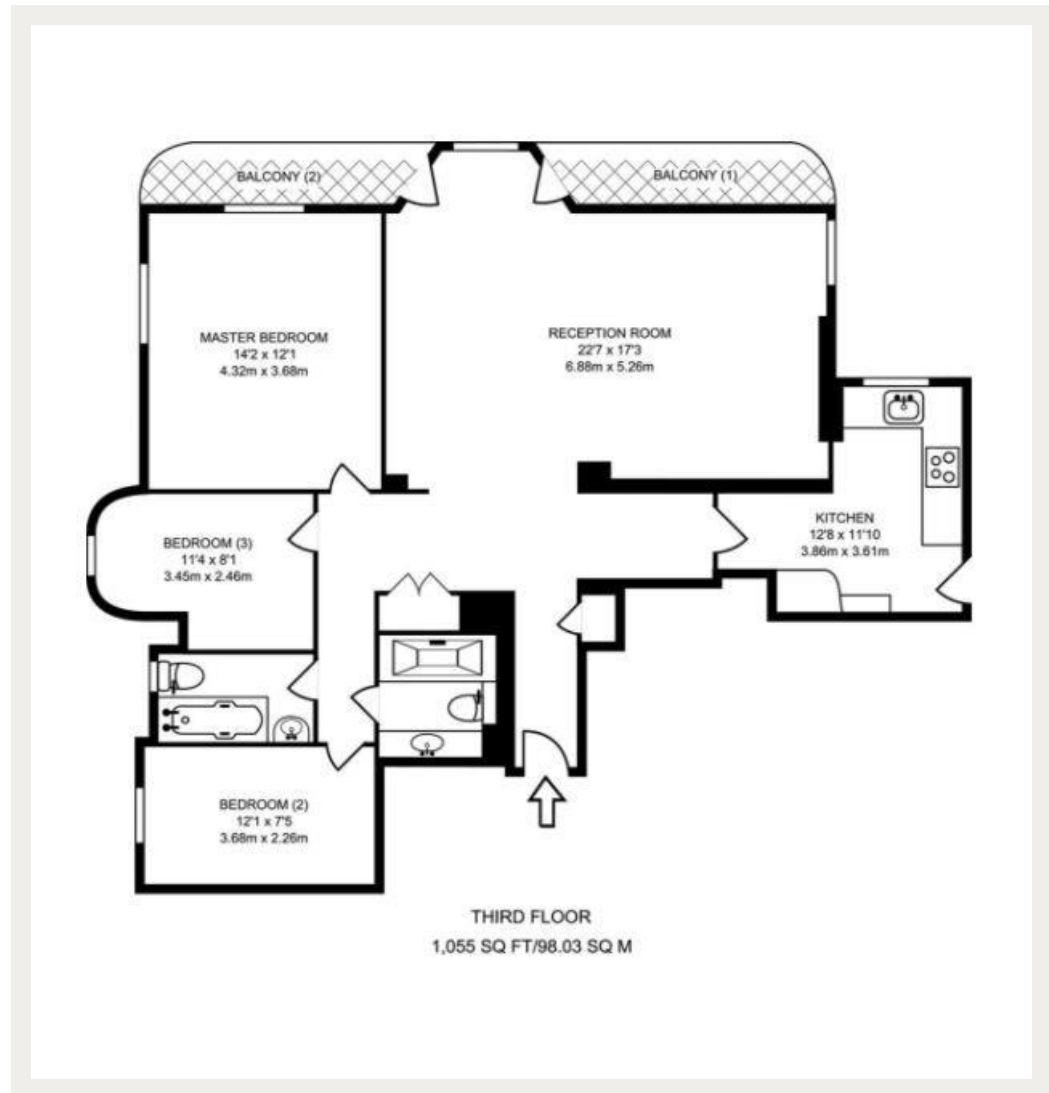

Whilst every effort is made to ensure the accuracy of these details, it should be noted that the measurements are approximate only. Floorplans are for representation purposes only and prepared according to the RICS Code of Measuring Practice by our floorplan provider. Therefore, the layout of doors, windows and rooms are approximate and should be regarded as such by any prospective tenant.

020 7096 9476

contact@landstones.co.uk