



Wallingford Avenue, W10

# Wallingford Avenue, W10

A beautifully finished semi-detached family home set in the heart of North Kensington.

This architecturally designed and fully refurbished house is arranged over three levels, featuring an open-plan kitchen and reception room, three bedrooms, and a low-maintenance garden at the rear.

Wallingford Avenue is a charming, tree-lined street, conveniently located near local shops, boutiques, and well-regarded schools. Latimer Road underground station (Circle and Hammersmith & City lines) is just 0.4 miles away, with the fabulous amenities of Westfield, Notting Hill, Portobello Road, and Golborne Road also within easy reach.

Council Tax Band: G (Kensington and Chelsea)  
Deposit: £12,500  
Garden details: Private Garden

Family House, Open Plan Kitchen, Architecturally Designed, Private Garden

**Asking price:** £2,500 pw

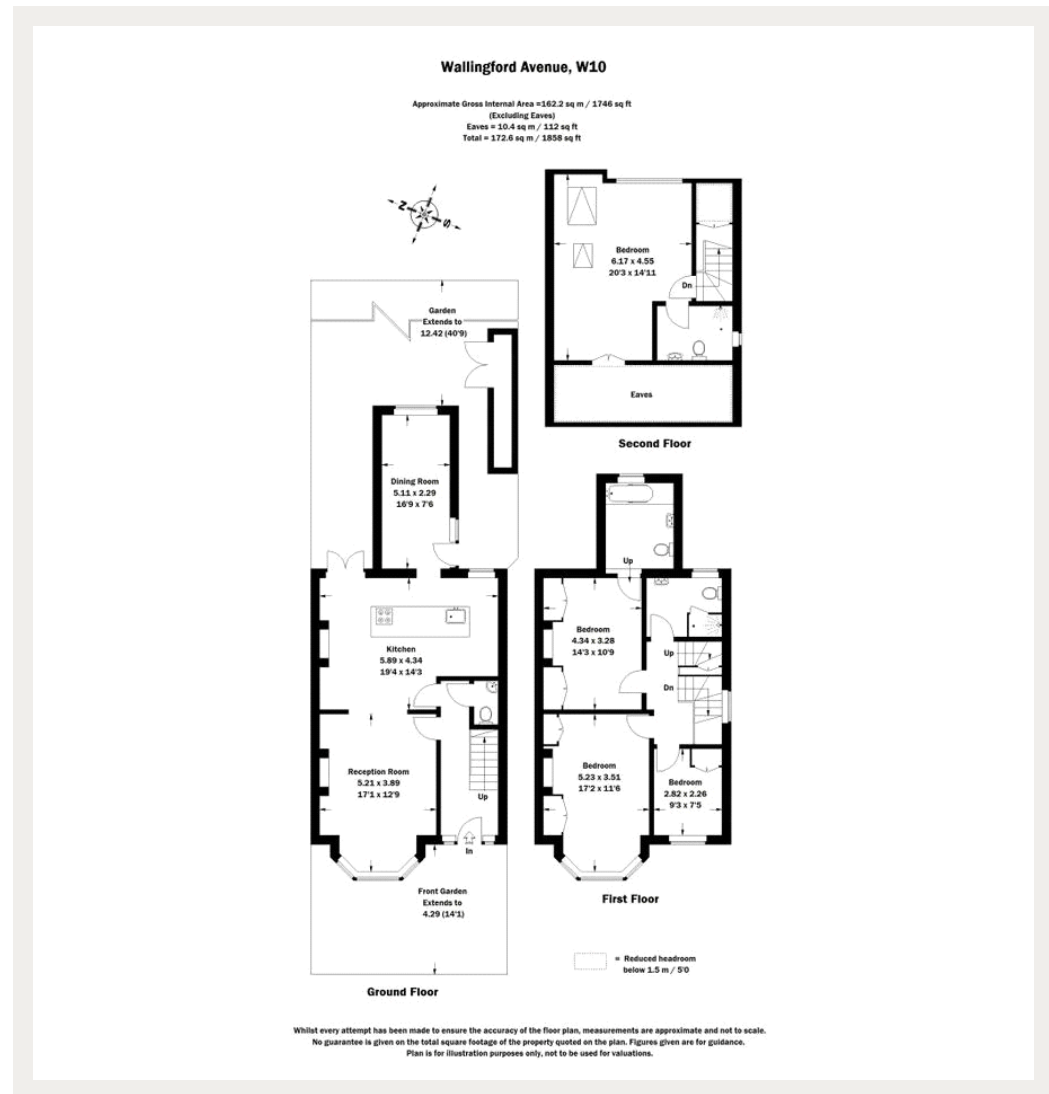

020 7096 9476

contact@landstones.co.uk