



**Moscow Mansions, SW5**



## Moscow Mansions, SW5

Beautifully presented and bright one double bedroom apartment to rent in this desirable mansion block.

The property is ideally located close to a wide range of shops and amenities situated on Earls Court Road. Both Gloucester Road and Earls Court underground station less than 0.3 miles away.

Council Tax Band: D

Deposit: £2,475

One Double Bedroom, Lift Access, Outdoor Space, South Facing

**Asking price:** £495 pw

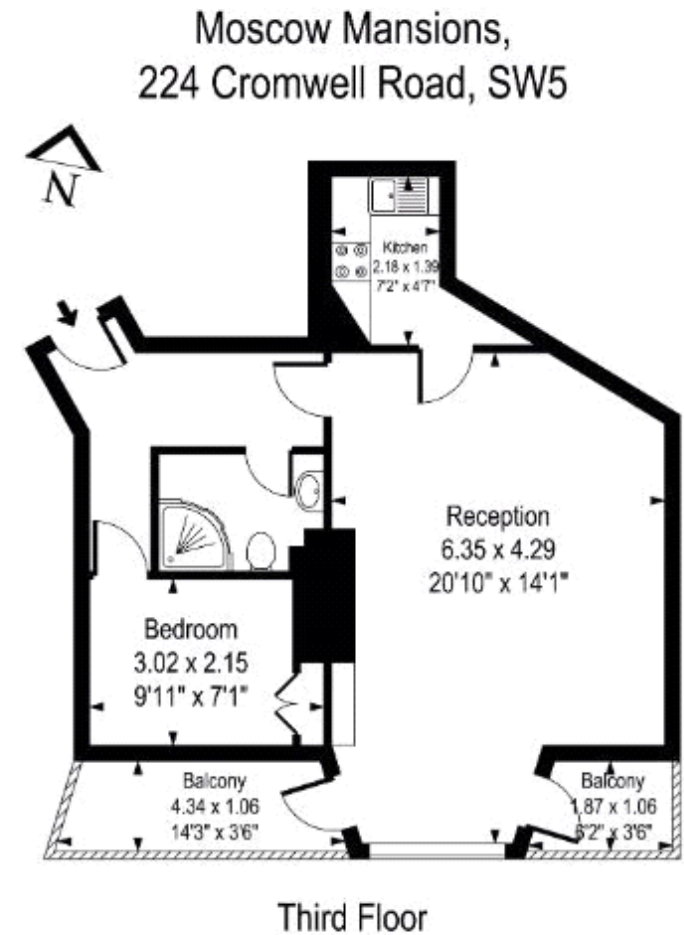

Whilst every effort is made to ensure the accuracy of these details, it should be noted that the measurements are approximate only. Floorplans are for representation purposes only and prepared according to the RICS Code of Measuring Practice by our floorplan provider. Therefore, the layout of doors, windows and rooms are approximate and should be regarded as such by any prospective tenant.

020 7096 9476

contact@landstones.co.uk