



Bedford Gardens, W8

Bedford Gardens, W8

Landstones are proud to present this beautifully refurbished two-bedroom, two-bathroom apartment with a balcony, located on the highly sought-after Bedford Gardens in Kensington.

Designed by WEST 11, this exceptional home has been finished to the highest standard. The bright open-plan kitchen and reception area is flooded with natural light thanks to dual-aspect windows, while two elegant bathrooms and bespoke built-in storage in both bedrooms add to the apartment's thoughtful layout and contemporary appeal.

Tucked away just off Kensington Church Street, Brunswick Gardens offers a peaceful yet highly convenient setting. Residents are moments from the vibrant cafés, independent bakeries, and boutique shops of both Kensington and Notting Hill. Ideally located, the property is equidistant from both High Street Kensington and Notting Hill Gate stations, offering excellent transport links via the Central, Circle, and District lines.

Newly Renovated, Excellent Location, Open Plan Kitchen, Balcony

Asking price: £1,150,000



BEDFORD GARDENS, W8
Approx. gross internal area
572 Sq Ft. / 53.1 Sq M.

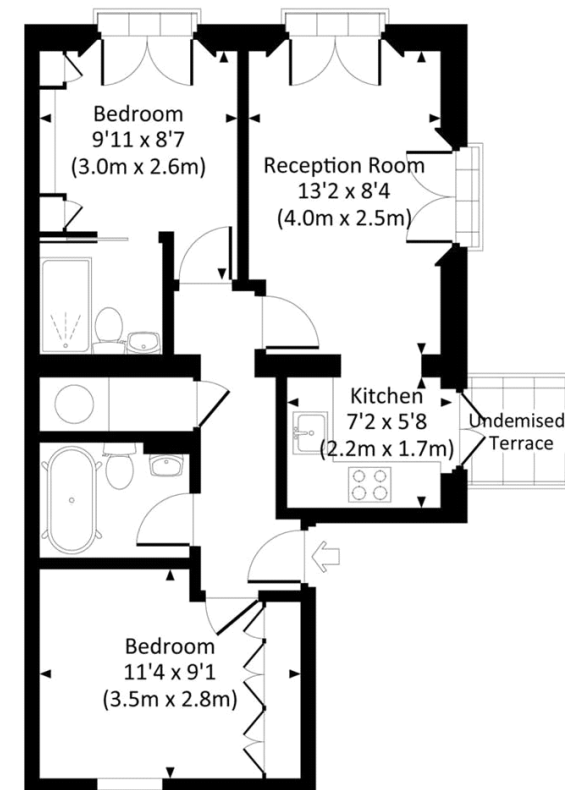

FIRST FLOOR

All measurements are approximate and for guidance and illustrative purposes only.
Photography and Floor Plans by www.rayco.london - +44 7793 974 209

020 7096 9476

contact@landstones.co.uk

Whilst every effort is made to ensure the accuracy of these details, it should be noted that the measurements are approximate only. Floorplans are for representation purposes only and prepared according to the RICS Code of Measuring Practice by our floorplan provider. Therefore, the layout of doors, windows and rooms are approximate and should be regarded as such by any prospective purchaser. Any internal photographs are intended as a guide only and it should not be assumed that any of the furniture/fittings are included in any sale. Where shown, details of lease, ground rent and service charge are provided by the vendor and their accuracy cannot be guaranteed, as the information may not have been verified and further checks should be made either through your solicitor/conveyance. Where appliances, including central heating, are mentioned, it cannot be assumed that they are in working order, as they have not been tested. Please also note that wiring, plumbing and drains have not been checked.