



Radnor Terrace, W14

## Radnor Terrace, W14

A wonderful one bedroom apartment located on the second floor of a sought after portered development with excellent leisure facilities.

Lord Kensington House was the fourth building to be completed in the "375 Kensington High Street" scheme being created by the renowned St Edward group. There is a 24hr concierge service, private cinema, residents' gym, swimming pool, sauna and spa facilities as well as a business conference suite. A short walk away from Olympia station and nearby Holland Park. Kensington (Olympia Station) is only a 5-minute walk.

Council Tax Band: F  
Deposit: £3,750

24/7 Concierge and Security, Air Conditioning, Cinema Room, Gym, Pool and Sauna, Private Terrace

**Asking price:** £750 pw

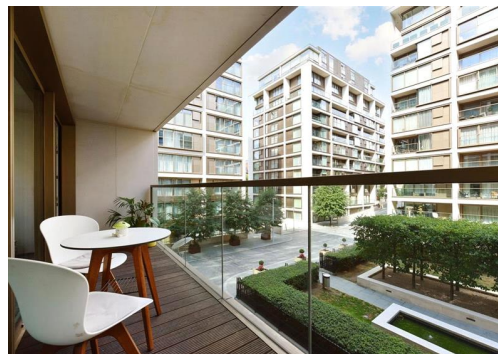

## Lord Kensington House, W14

Approximate gross internal area

516 sq ft / 47.94 sq m

Approximate gross external area

103 sq ft / 9.57 sq m



Second Floor

Illustration For Identification Purposes Only. Not To Scale  
\*Floorplan Drawn According To RICS Guidelines  
Copyright of FeaturePRO

020 7096 9476

contact@landstones.co.uk

Whilst every effort is made to ensure the accuracy of these details, it should be noted that the measurements are approximate only. Floorplans are for representation purposes only and prepared according to the RICS Code of Measuring Practice by our floorplan provider. Therefore, the layout of doors, windows and rooms are approximate and should be regarded as such by any prospective tenant.