



Shepherd Street, W1J

# Shepherd Street, W1J

Landstones is pleased to present this newly refurbished four-bedroom townhouse, offering private outdoor space, air conditioning, and over 2,500 sq ft of elegant living accommodation arranged over four floors in the prestigious heart of Mayfair.

This beautifully presented home has been meticulously refurbished to a high specification, featuring quality finishes throughout, including wood flooring and a sleek, open-plan kitchen tailored for modern living. Air conditioning ensures year-round comfort, while dual-aspect windows flood the spacious reception room with natural light and lead out onto a private balcony-perfect for enjoying fresh air and views over this sought-after central London setting.

Occupying the entire third floor, the principal bedroom suite boasts generous built-in wardrobes, a luxurious en-suite bathroom, and access to a private terrace-creating a tranquil and spacious retreat. The second and third bedrooms also benefit from excellent built-in storage, while the fourth bedroom offers flexibility as a guest room, home office, or additional living space.

Additional features include a cellar and a separate utility room, providing valuable storage and added convenience.

Situated on the picturesque Shepherd Street, just moments from the vibrant Shepherd Market, the property enjoys a peaceful yet central location. Residents are surrounded by charming boutiques, cafés, and traditional pubs, with the world-class amenities of Piccadilly, Park Lane, and Oxford Street just a short stroll away.

Council Tax Band: H (Westminster)

Tenure: Freehold

Garden details: Terrace

Brand New Refurbished, Private Terrace, Air Conditioning

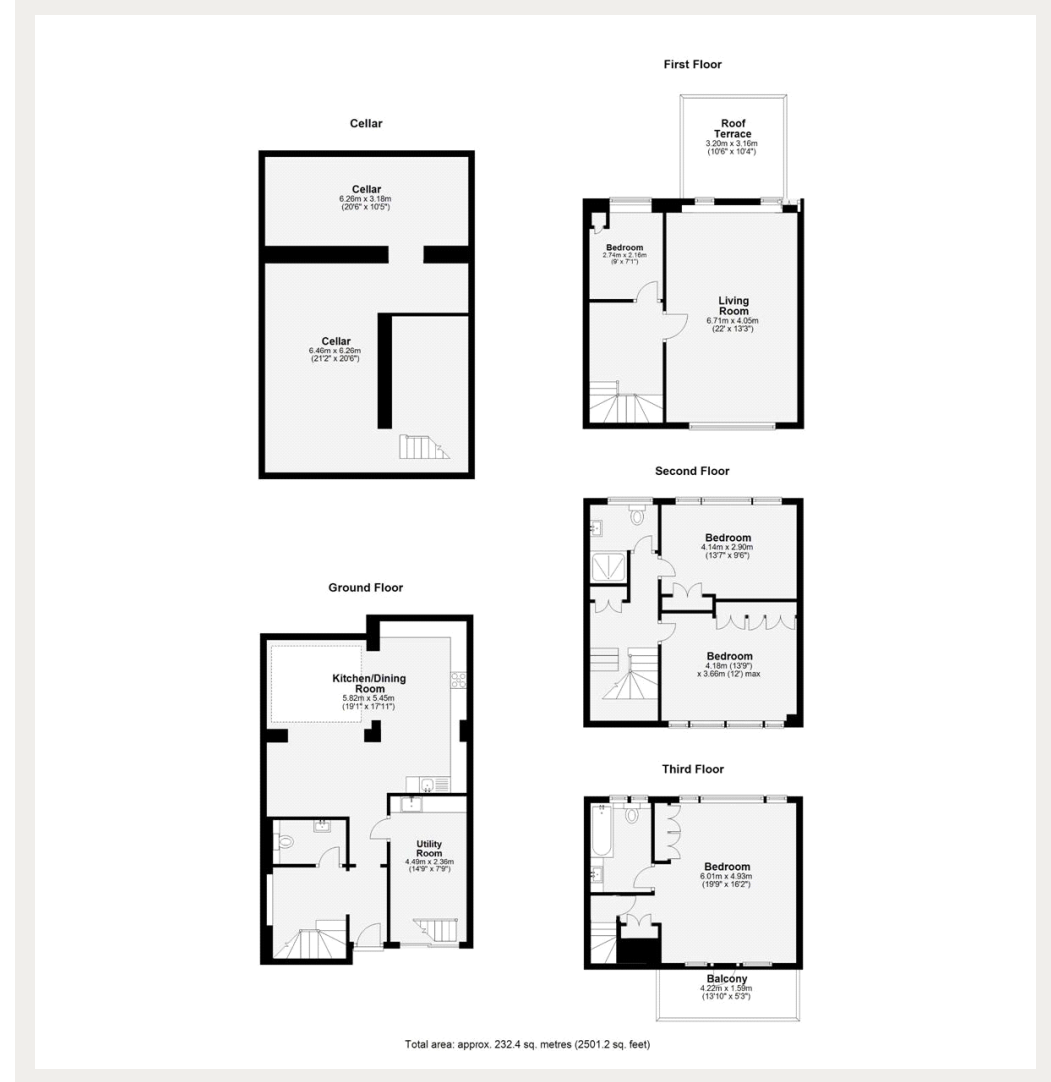

**Asking price:** Guide Price £6,000,000

020 7096 9476

contact@landstones.co.uk

Whilst every effort is made to ensure the accuracy of these details, it should be noted that the measurements are approximate only. Floorplans are for representation purposes only and prepared according to the RICS Code of Measuring Practice by our floorplan provider. Therefore, the layout of doors, windows and rooms are approximate and should be regarded as such by any prospective purchaser. Any internal photographs are intended as a guide only and it should not be assumed that any of the furniture/fitings are included in any sale. Where shown, details of lease, ground rent and service charge are provided by the vendor and their accuracy cannot be guaranteed, as the information may not have been verified and further checks should be made either through your solicitor/conveyance. Where appliances, including central heating, are mentioned, it cannot be assumed that they are in working order, as they have not been tested. Please also note that wiring, plumbing and drains have not been checked.