



Onslow Square, SW7

Onslow Square, SW7

A beautifully refurbished, turn-key three-bedroom apartment set within a prestigious garden square in the heart of South Kensington. This well-proportioned home benefits from a private terrace, a long lease, and is positioned within a well-maintained period building.

Meticulously renovated to a high specification, the property blends timeless elegance with modern convenience. The apartment features three spacious double bedrooms, two of which benefit from en-suite bathrooms, and all with built-in storage - offering generous space for family living, guests, or flexible use as a home office. The well-planned reception room provides an ideal setting for both entertaining and everyday living, with access to a private terrace overlooking the beautifully kept communal gardens. Thoughtfully designed storage throughout the apartment enhances practicality and ease of living.

Onslow Square is considered one of London's most sought-after garden squares, offering access to two stunning communal gardens. The East Gardens provide open green space, benches, walking paths, and a children's play area, while the West Gardens offer a more intimate, manicured setting complete with a floodlit residents' tennis court.

Ideally located just moments from South Kensington Underground Station (District, Circle, and Piccadilly lines), this prime address offers excellent connectivity to the City, the West End, and Heathrow Airport. For families, the highly regarded Lycée Français Charles de Gaulle is within easy walking distance.

The local area boasts a wide selection of boutiques, restaurants, and cafés along Old Brompton Road and Fulham Road, as well as world-renowned cultural institutions nearby - making this a truly exceptional home in one of London's most desirable neighbourhoods.

Tenure: Leasehold

020 7096 9476

contact@landstones.co.uk

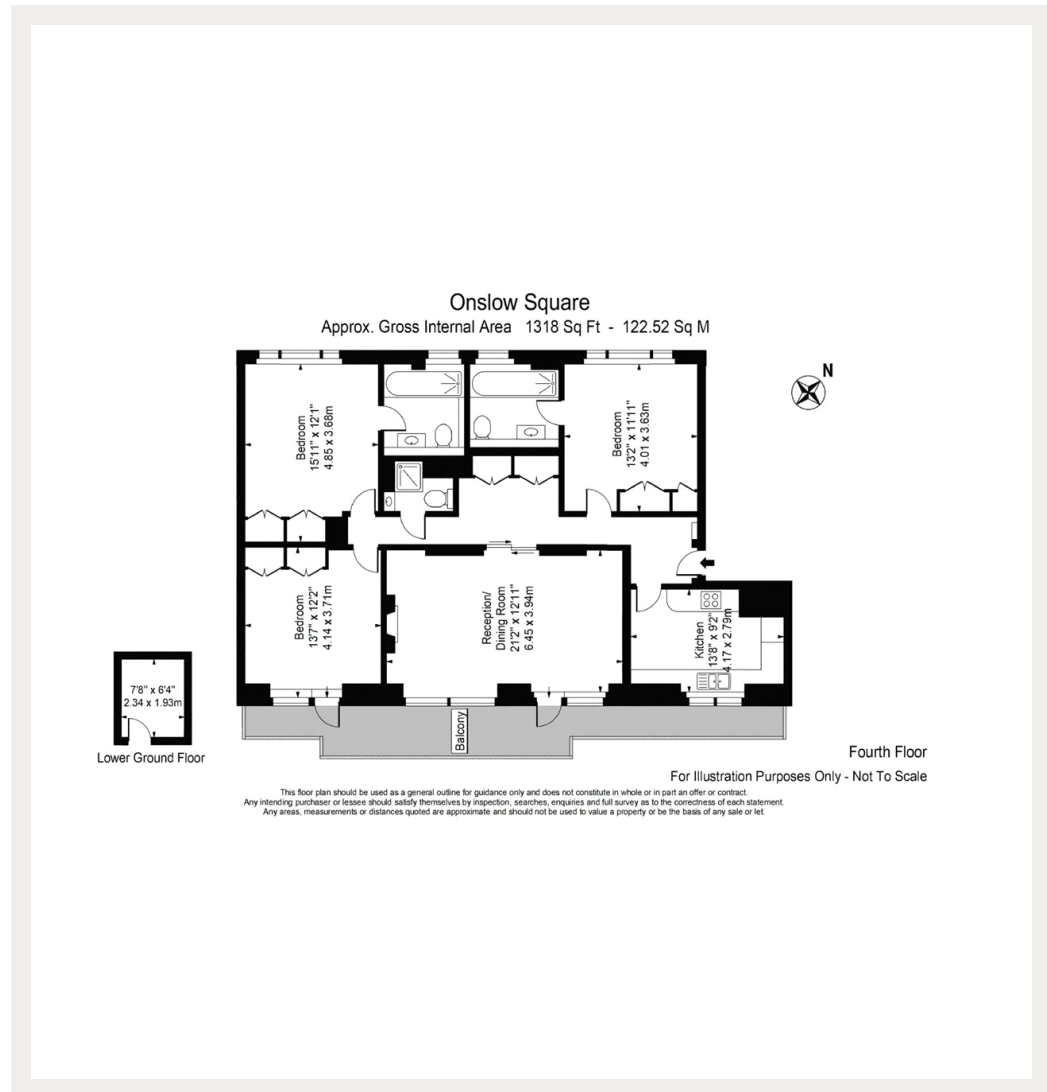

Whilst every effort is made to ensure the accuracy of these details, it should be noted that the measurements are approximate only. Floorplans are for representation purposes only and prepared according to the RICS Code of Measuring Practice by our floorplan provider. Therefore, the layout of doors, windows and rooms are approximate and should be regarded as such by any prospective purchaser. Any internal photographs are intended as a guide only and it should not be assumed that any of the furniture/fittings are included in any sale. Where shown, details of lease, ground rent and service charge are provided by the vendor and their accuracy cannot be guaranteed, as the information may not have been verified and further checks should be made either through your solicitor/conveyance. Where appliances, including central heating, are mentioned, it cannot be assumed that they are in working order, as they have not been tested. Please also note that wiring, plumbing and drains have not been checked.