



Gloucester Road, SW7

Gloucester Road, SW7

Offered on a Short-Let basis, this bright two-bedroom flat offers 668 sq ft of stylish living on the second floor of a charming period building.

The accommodation offers well-proportioned living space throughout.

The property features a generous open-plan kitchen and reception room extending across the full width of the building, perfect for both entertaining and everyday living.

Ideally positioned just moments from Gloucester Road station, the flat enjoys superb transport connections (District, Circle and Piccadilly lines) and easy access to Hyde Park and Kensington Gardens. The area is well served by a wide choice of cafés, restaurants and independent shops.

The property is also conveniently located for Imperial College, the Royal Albert Hall, and the world-renowned museums of South Kensington, including the Natural History Museum.

Council Tax Band: E
Deposit: £6,900

All Bills Inclusive , Short Let

Asking price: £1,150 pw



Gloucester Road, SW7

■ Approximate Gross Internal Area
62.07 sq m / 668 sq ft

■ Storage
3.90 sq m / 42 sq ft

Total Areas Shown On Plan
65.96 sq m / 710 sq ft

(CH = Ceiling Heights)

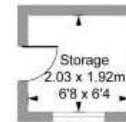

(Not shown in actual location
or orientation)

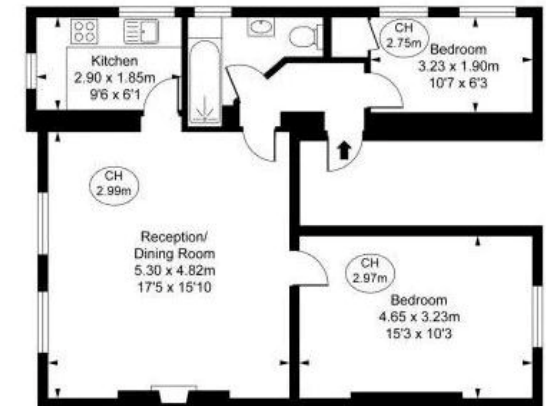

020 7096 9476

contact@landstones.co.uk

Whilst every effort is made to ensure the accuracy of these details, it should be noted that the measurements are approximate only. Floorplans are for representation purposes only and prepared according to the RICS Code of Measuring Practice by our floorplan provider. Therefore, the layout of doors, windows and rooms are approximate and should be regarded as such by any prospective tenant.