



Gloucester Mews, W2

## Gloucester Mews, W2

A truly stunning and immaculately presented turnkey two-bedroom apartment with private outdoor space, offered to the market with a share of freehold.

The property features a generous open-plan layout, creating a warm and inviting atmosphere ideal for relaxing or entertaining. The sleek, contemporary kitchen is fitted with high-quality appliances, complementing the stylish and thoughtfully designed living area - making this the perfect London pied-à-terre.

Tucked away on the quiet and secluded Gloucester Mews, the location provides a peaceful retreat while remaining just moments from excellent local amenities. Lancaster Gate Station (Central Line) is within walking distance, providing swift access across the city and West London, while Paddington Station offers mainline and Elizabeth Line connections throughout the UK and to Heathrow Airport. For those who enjoy green open spaces, Hyde Park is only a short stroll away, offering an oasis in the heart of London.

Tenure: Share of Freehold

Close to Hyde Park, Modern Design, Private Storage Vault, Secluded Mews

**Asking price: £800,000**

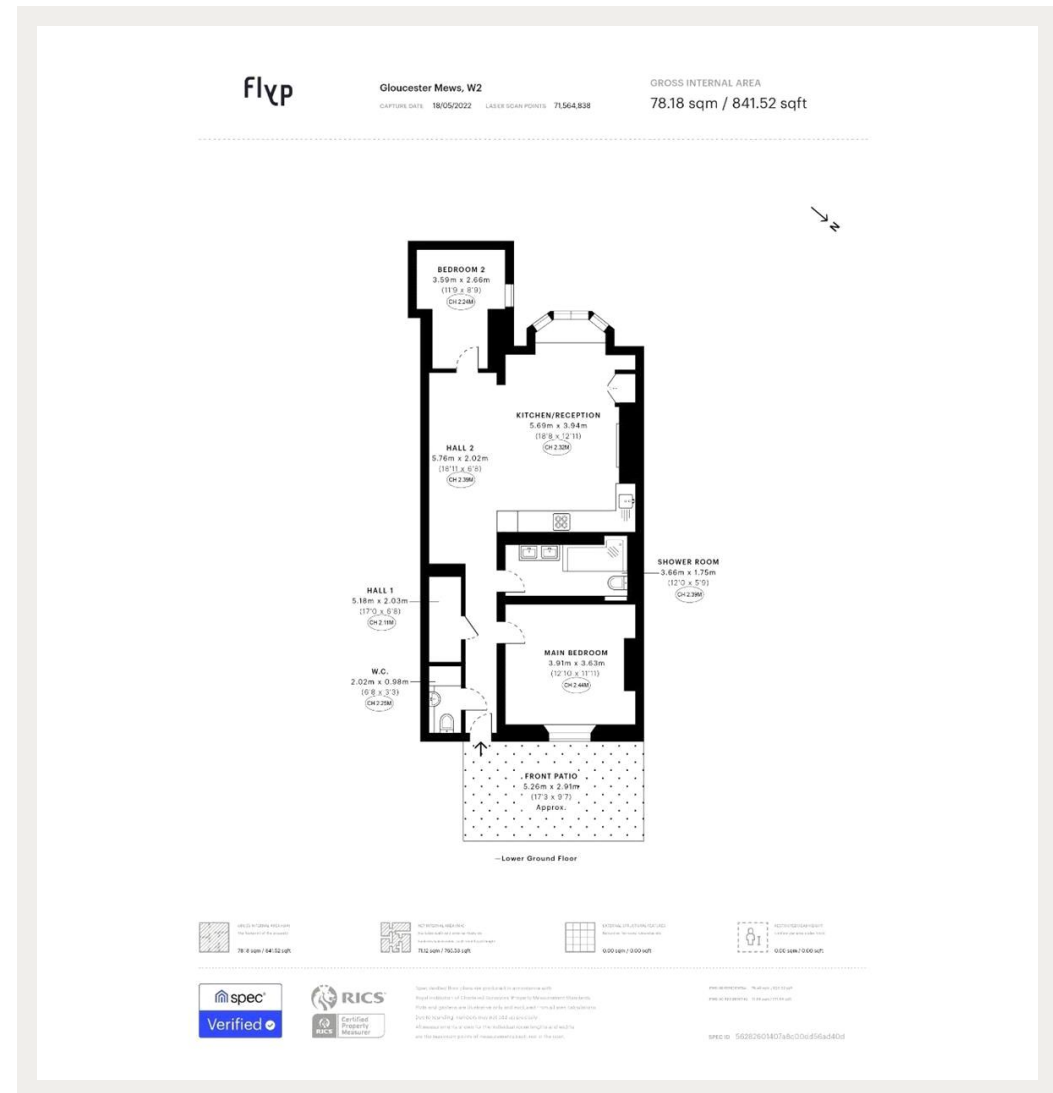

020 7096 9476

contact@landstones.co.uk

Whilst every effort is made to ensure the accuracy of these details, it should be noted that the measurements are approximate only. Floorplans are for representation purposes only and prepared according to the RICS Code of Measuring Practice by our floorplan provider. Therefore, the layout of doors, windows and rooms are approximate and should be regarded as such by any prospective purchaser. Any internal photographs are intended as a guide only and it should not be assumed that any of the furniture/fitings are included in any sale. Where shown, details of lease, ground rent and service charge are provided by the vendor and their accuracy cannot be guaranteed, as the information may not have been verified and further checks should be made either through your solicitor/conveyance. Where appliances, including central heating, are mentioned, it cannot be assumed that they are in working order, as they have not been tested. Please also note that wiring, plumbing and drains have not been checked.