



Randolph Road, London

Randolph Road, London

This exceptional four-bedroom mews house of over 1,800 sq ft offers a rare combination of space, style, and privacy in one of central London's most charming residential neighbourhoods.

Arranged over three floors and presented in very good condition, the house boasts large, well-proportioned rooms, a stylish contemporary interior, and wooden flooring throughout. The property is flooded with natural light thanks to its large windows, creating a bright and welcoming atmosphere while remaining highly practical for everyday living.

At the heart of the home is a generous dining area with an open-plan kitchen, perfectly designed for family life and entertaining. The house further benefits from a large private gated terrace, ideal for enjoying a drink in the sunshine, hosting friends, or providing a safe outdoor space for children to play.

With its spacious bedrooms, excellent layout, and abundance of light, this home is ideally suited to families or couples relocating to London who wish to live centrally while enjoying the feel of a quiet, residential, village-like neighbourhood.

Set in the heart of Little Venice, just moments from Regent's Canal, residents enjoy a peaceful and picturesque setting while remaining close to the vibrancy of the West End. The area is well known for its charming cafés and restaurants, all within easy reach, as well as the iconic Rembrandt Gardens, perfectly positioned between Hyde Park and Regent's Park.

Superb transport links are provided by Warwick Avenue and Royal Oak underground stations, offering excellent connectivity across London, while Paddington Station provides a direct link to Heathrow Airport.

A truly special home combining generous living space, outdoor living, and a prime central location within a sought

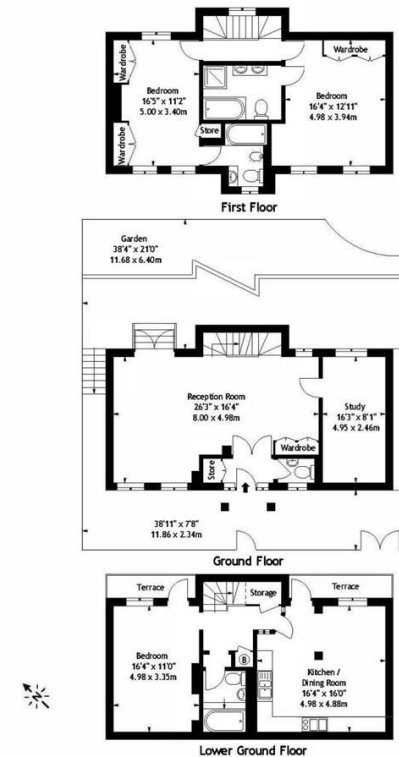

RANDOLPH ROAD, W9

APPROX GROSS INTERNAL AREA
1809 Sq Ft - 169 Sq Mtr

020 7096 9476

contact@landstones.co.uk

Whilst every effort is made to ensure the accuracy of these details, it should be noted that the measurements are approximate only. Floorplans are for representation purposes only and prepared according to the RICS Code of Measuring Practice by our floorplan provider. Therefore, the layout of doors, windows and rooms are approximate and should be regarded as such by any prospective tenant.