



Sutherland Place, W2

Sutherland Place, W2

Landstones are proud to present this superb split-level upper maisonette in the heart of Notting Hill, complete with rare outdoor space just moments from Westbourne Grove.

Set within one of Notting Hill's colourful period townhouses, this beautifully arranged home offers the very best of West London living.

Entering on the first floor, an open staircase leads to the second level where you will find two generous double bedrooms, both featuring large sash windows that flood the rooms with natural light. This floor also accommodates a spacious and contemporary family bathroom with a full-sized bathtub.

The top floor opens into an impressive reception and entertaining space. Double French doors lead out to a charming parapet balcony, while overhead skylights and additional windows ensure the room is bathed in light throughout the day. The open-plan kitchen integrates seamlessly into the space, creating an ideal setting for hosting or relaxing. The overall design has been carefully considered to provide a calm and private retreat, just moments from the vibrant energy of Westbourne Grove.

Sutherland Place is a quiet residential street in the heart of Notting Hill, a short stroll from the boutiques, cafés and lifestyle offerings of Westbourne Grove. The renowned The Ledbury, holder of three Michelin stars, is nearby, as is Portobello Road with its famous market and cultural charm. Notting Hill Gate Underground Station provides excellent connections across London and direct access towards Heathrow, while Paddington Station offers national rail services and the Heathrow Express.

Council Tax Band: F (Westminster)
Tenure: Share of Freehold
Garden details: Terrace

020 7096 9476

contact@landstones.co.uk

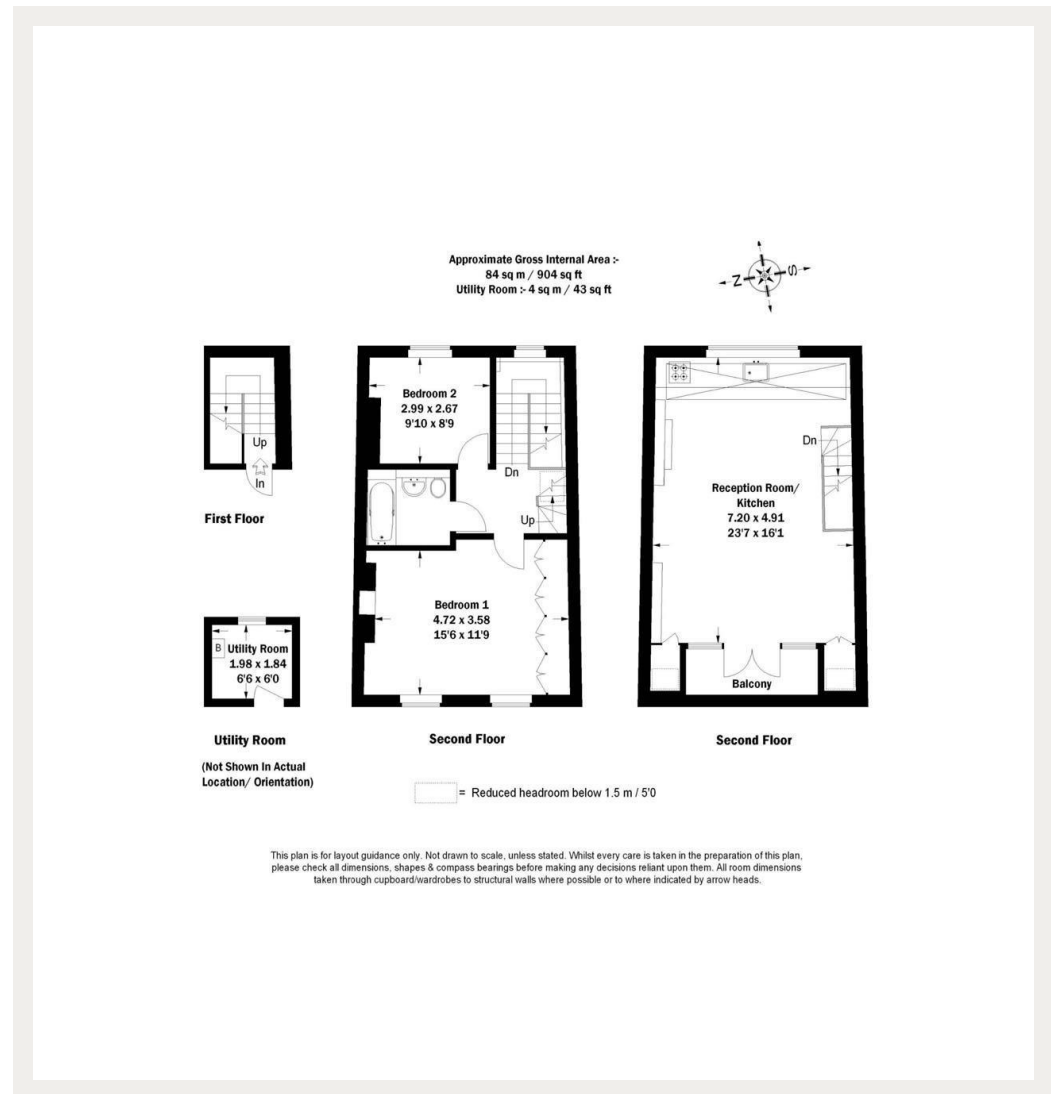

Whilst every effort is made to ensure the accuracy of these details, it should be noted that the measurements are approximate only. Floorplans are for representation purposes only and prepared according to the RICS Code of Measuring Practice by our floorplan provider. Therefore, the layout of doors, windows and rooms are approximate and should be regarded as such by any prospective purchaser. Any internal photographs are intended as a guide only and it should not be assumed that any of the furniture/fittings are included in any sale. Where shown, details of lease, ground rent and service charge are provided by the vendor and their accuracy cannot be guaranteed, as the information may not have been verified and further checks should be made either through your solicitor/conveyance. Where appliances, including central heating, are mentioned, it cannot be assumed that they are in working order, as they have not been tested. Please also note that wiring, plumbing and drains have not been checked.