



Basil Street, SW3

Basil Street, SW3

An exceptional two-bedroom apartment set on the fourth floor of the prestigious Lincoln House on Basil Street, in the heart of Knightsbridge. Positioned moments from Harrods and the world-class boutiques and restaurants of Sloane Street, the location is every bit as impressive as the home itself.

From the moment you enter, the quality of finish and attention to detail are clear. The reception room is beautifully presented, with large windows drawing in natural light and enhancing the sense of space. Clean architectural lines, refined materials and elegant styling create a sophisticated yet comfortable setting, equally suited to quiet evenings in or hosting guests.

The apartment comprises two generous double bedrooms. The well-appointed principal bedroom features a king-size bed, excellent built-in wardrobe space and a luxurious en suite bathroom with a spacious walk-in shower. Double sash windows flood the room with natural light, creating a calm and inviting retreat. The second bedroom is similarly well proportioned and is served by a stylish separate bathroom, ideal for guests or family.

A contemporary separate kitchen is fitted with high-specification appliances and sleek cabinetry, combining practicality with understated style. The adjacent dining area offers an elegant space for both everyday meals and more formal entertaining.

Further benefits include a substantial utility room with a stacked washer and separate dryer, thoughtfully positioned to keep laundry discreetly tucked away from the main living areas.

Lincoln House is a highly regarded and well-maintained mansion block with lift access and porter service, providing both convenience and security. With Hyde Park just a short stroll away and Knightsbridge Underground Station close by, this apartment represents an

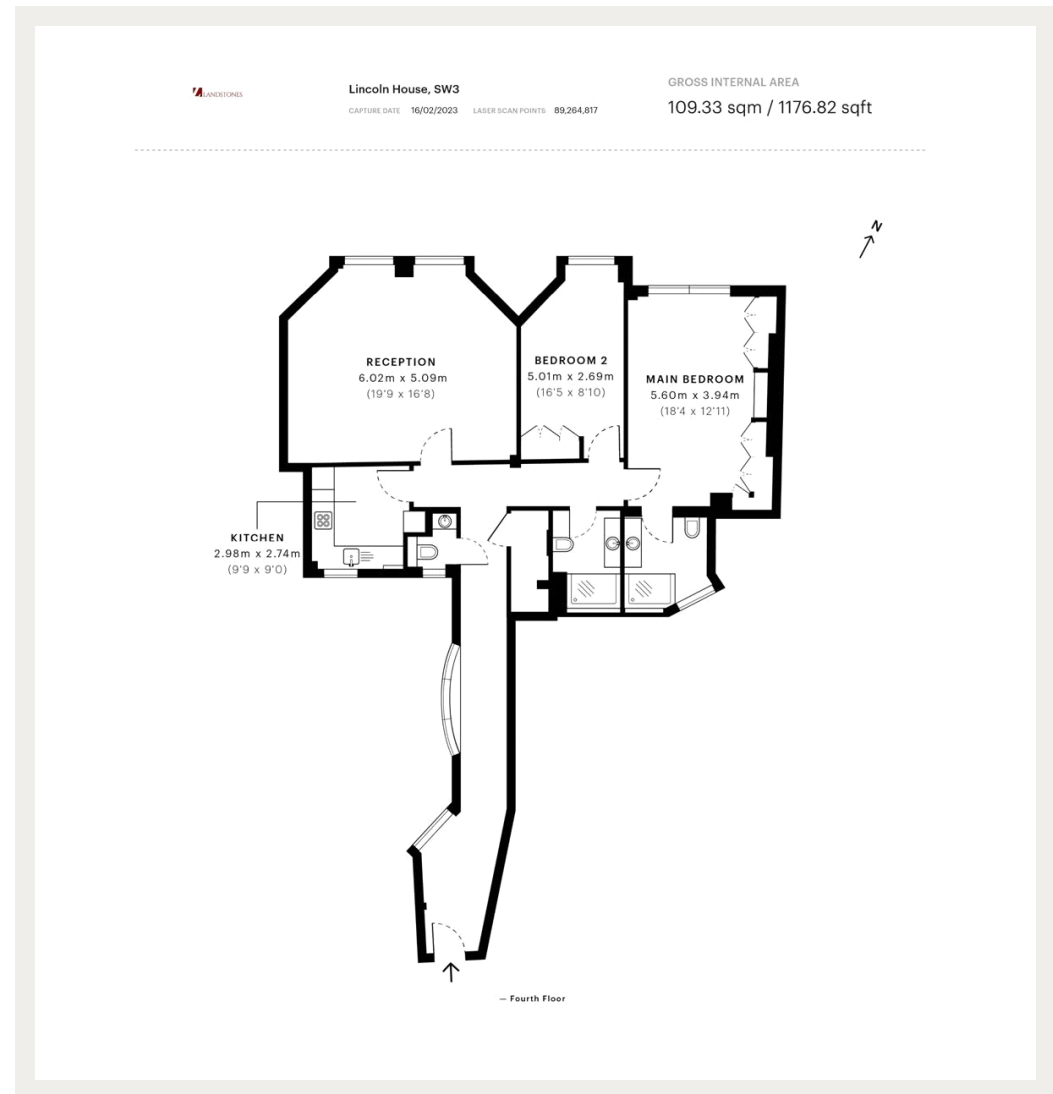

Whilst every effort is made to ensure the accuracy of these details, it should be noted that the measurements are approximate only. Floorplans are for representation purposes only and prepared according to the RICS Code of Measuring Practice by our floorplan provider. Therefore, the layout of doors, windows and rooms are approximate and should be regarded as such by any prospective purchaser. Any internal photographs are intended as a guide only and it should not be assumed that any of the furniture/fittings are included in any sale. Where shown, details of lease, ground rent and service charge are provided by the vendor and their accuracy cannot be guaranteed, as the information may not have been verified and further checks should be made either through your solicitor/conveyance. Where appliances, including central heating, are mentioned, it cannot be assumed that they are in working order, as they have not been tested. Please also note that wiring, plumbing and drains have not been checked.

020 7096 9476

contact@landstones.co.uk