



Whiteheads Grove, SW3

## Whiteheads Grove, SW3

A beautifully presented three-bedroom lateral apartment set within a well-maintained Chelsea portered building, offering 24/7 portering and lift access.

Ideally positioned just a short walk from the vibrant Sloane Avenue and King's Road, this home is perfectly placed for the very best of Chelsea living.

The rare corner position maximises space far better than a traditional corridor layout, while the dual aspect provides fantastic natural light and far-reaching views towards the Natural History Museum.

Finished to a tasteful standard throughout, the property features a generous separate reception room with a feature fireplace, creating a warm and sociable space to relax or entertain. Thoughtfully designed storage solutions and an inviting dining area further enhance the practicality of the apartment.

Cranmer Court offers 24-hour portering, communal gardens, and an unrivalled location on the newly designed Chelsea Green. Residents are moments from boutique shops, cafés, and restaurants, with convenient access to King's Road, Fulham Road, Sloane Square, and South Kensington stations.

Tenure: Leasehold

Asking price: £1,300,000



## Whiteheads Grove, SW3 3HG

Approx Gross Internal Area = 88 sq m / 947 sq ft

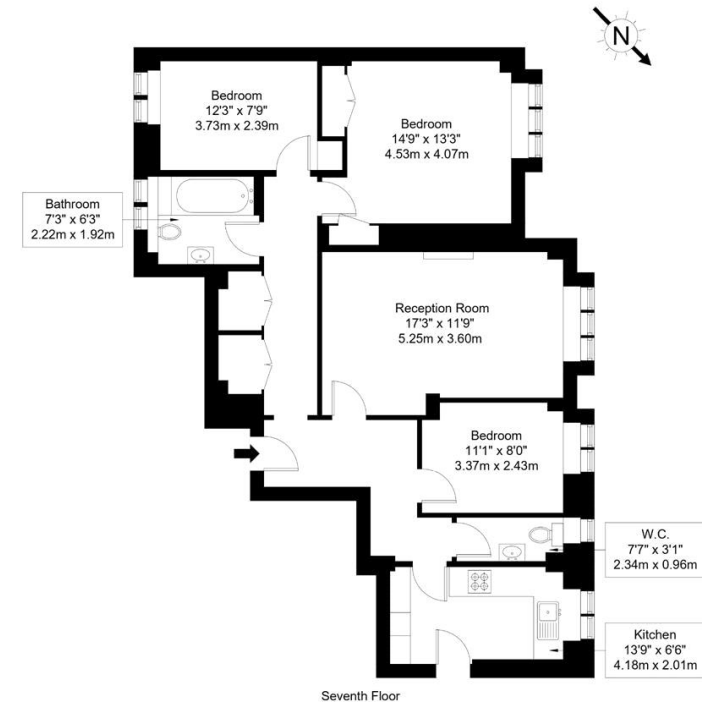

Ref :

Copyright **BLEU PLAN**

The Floor plan is not to scale and measurements and areas shown are approximate and therefore should be used for illustrative purposes only. The plan has been prepared in accordance with the RICS code of Measuring Practice and whilst we have confidence in the information produced it must not be relied on. Maximum lengths and widths are represented on the floor plan. If there is any aspect of particular importance, you should carry out or commission your own inspection of the property.  
Copyright @ BLEUPLAN

020 7096 9476

contact@landstones.co.uk

Whilst every effort is made to ensure the accuracy of these details, it should be noted that the measurements are approximate only. Floorplans are for representation purposes only and prepared according to the RICS Code of Measuring Practice by our floorplan provider. Therefore, the layout of doors, windows and rooms are approximate and should be regarded as such by any prospective purchaser. Any internal photographs are intended as a guide only and it should not be assumed that any of the furniture/fittings are included in any sale. Where shown, details of lease, ground rent and service charge are provided by the vendor and their accuracy cannot be guaranteed, as the information may not have been verified and further checks should be made either through your solicitor/conveyance. Where appliances, including central heating, are mentioned, it cannot be assumed that they are in working order, as they have not been tested. Please also note that wiring, plumbing and drains have not been checked.