



Edgware Road, W2

## Edgware Road, W2

Short Let. This bright one-bedroom flat on the fourth floor (with lift) offers modern finishes and the convenience of a porter.

Spread across 540 sq ft, the apartment benefits from a well-designed, practical layout that maximises space and natural light. It features elegant wooden flooring, ample storage, and clean contemporary finishes, making it an ideal home for professionals or anyone seeking a refined central London base.

Perfectly positioned, the flat is just moments from a wide variety of shops, cafés, and restaurants. With outstanding transport links via Edgware Road, Marble Arch, and Paddington stations, you'll enjoy effortless access across central London and beyond. The renowned boutiques and village charm of Marylebone High Street are also nearby, offering the perfect blend of convenience and luxury.

A fantastic opportunity to secure a bright, well-laid-out home in one of London's most desirable neighbourhoods.

Deposit: £4,116

All Bills Inclusive , Lift Access, Porter

**Asking price:** £950 pw

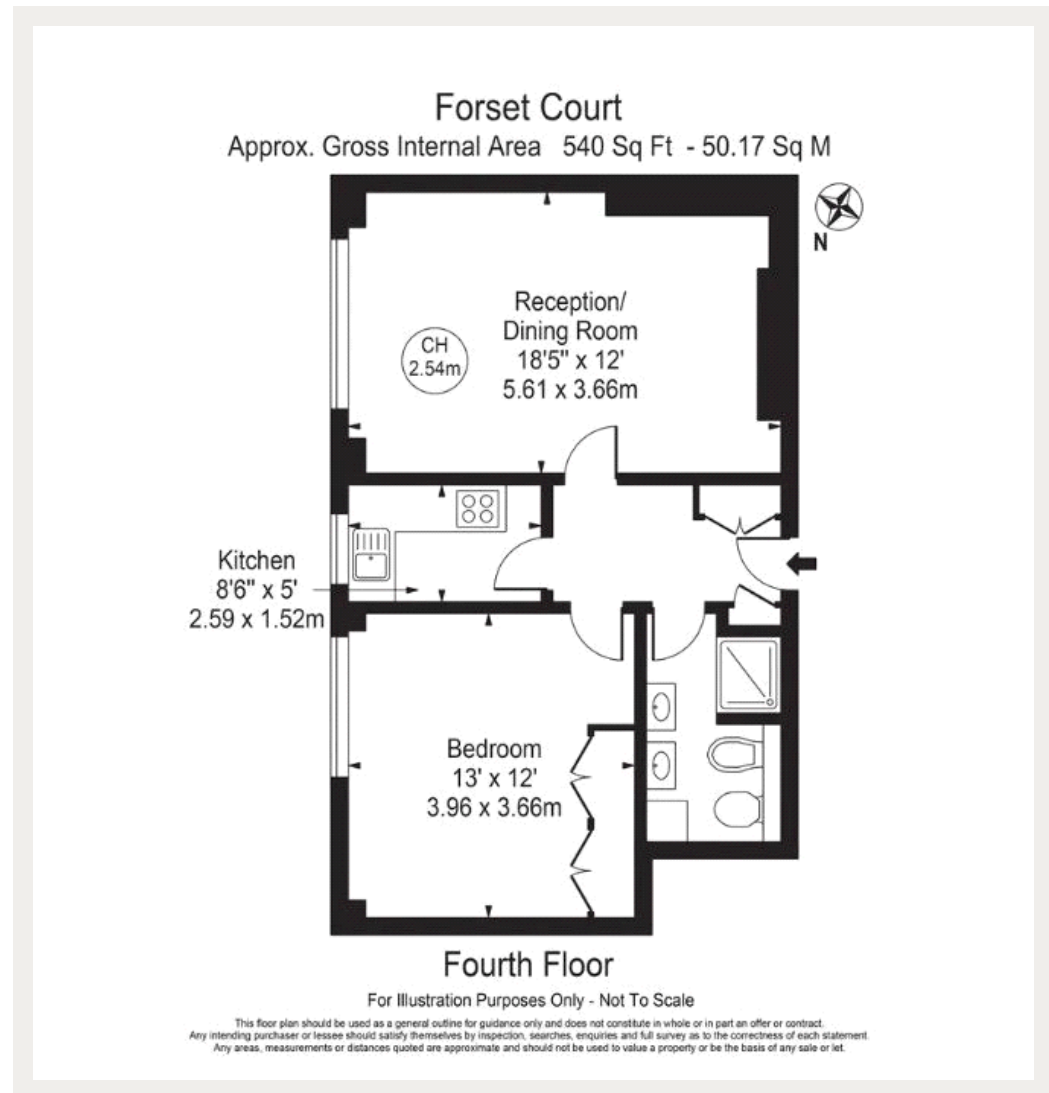

020 7096 9476

contact@landstones.co.uk

Whilst every effort is made to ensure the accuracy of these details, it should be noted that the measurements are approximate only. Floorplans are for representation purposes only and prepared according to the RICS Code of Measuring Practice by our floorplan provider. Therefore, the layout of doors, windows and rooms are approximate and should be regarded as such by any prospective tenant.