



Redfield Lane, SW5

Redfield Lane, SW5

A beautifully refurbished south-facing three-bedroom freehold house with the rare luxury of a private garage, offering in excess of 2,000 sq ft of elegant internal living space, quietly positioned behind a secure gated entrance within one of the area's most charming enclaves.

From the moment of arrival, the property offers a wonderful sense of privacy and tranquillity, discreetly tucked away from the bustle of the city while remaining moments from some of West London's most vibrant amenities. Thoughtfully redesigned and refurbished by the current owners, the house effortlessly blends contemporary finishes with the timeless character associated with classic London architecture.

The first floor forms the heart of the home and has been designed with both entertaining and modern family living in mind. The impressive open-plan kitchen and dining space is beautifully proportioned, centred around a sleek contemporary kitchen complete with integrated appliances and a striking freestanding island that naturally becomes the focal point of the room. Whether hosting guests, enjoying relaxed weekend breakfasts, or entertaining into the evening, the space has been carefully arranged to create a warm and sociable atmosphere. A generous formal dining area sits comfortably alongside, making the room equally suited to larger gatherings and everyday living alike.

Flowing seamlessly from the kitchen is a second reception room, currently arranged as an elegant formal living area. Cleverly separated while maintaining an open and connected feel, the layout provides exceptional flexibility depending on lifestyle requirements, creating distinct areas for relaxing, entertaining, or working from home without compromising the sense of space and light.

Throughout these reception spaces, beautiful sash windows, characteristic of traditional London period homes, draw in an abundance of natural light from multiple aspects. Combined with the desirable southerly

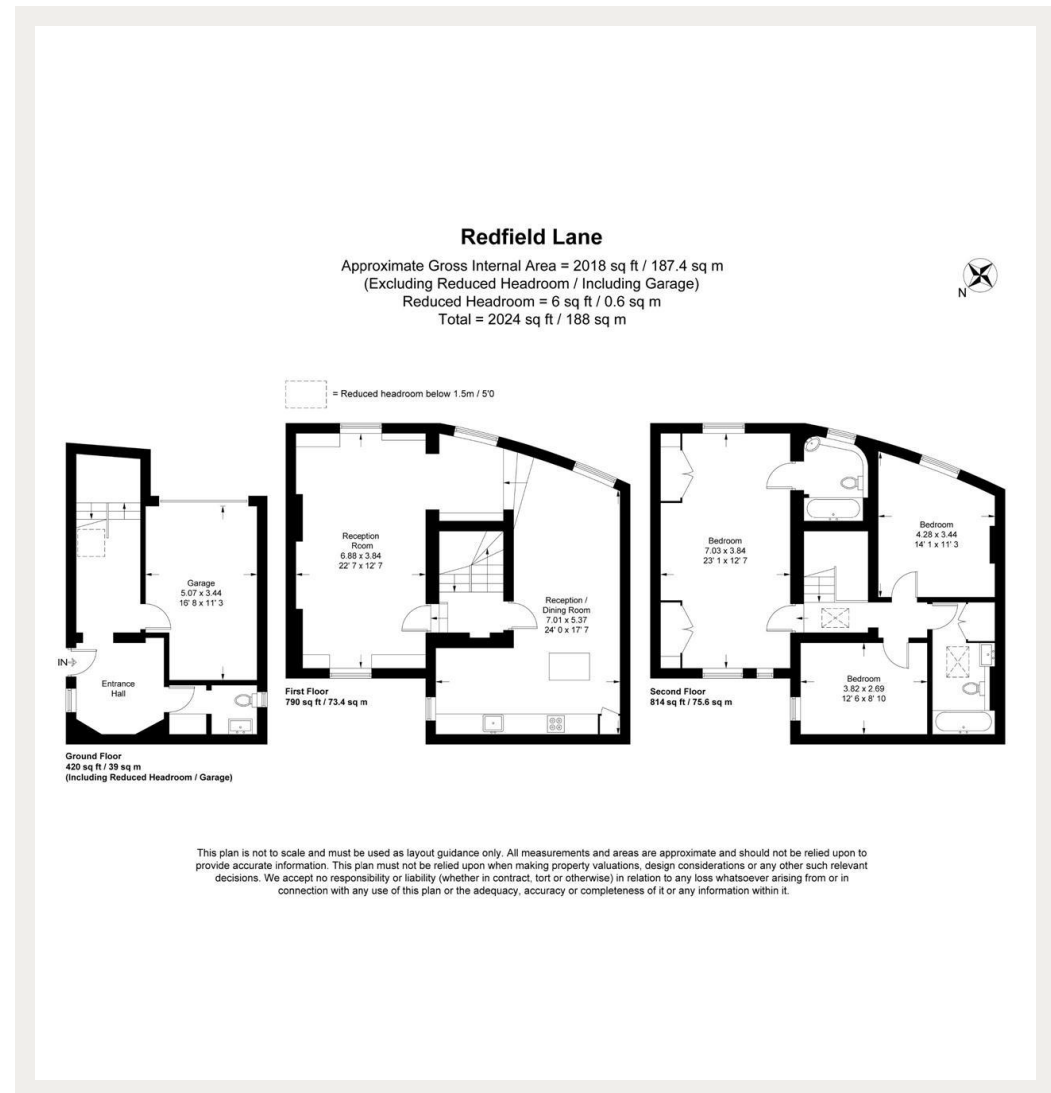

020 7096 9476

contact@landstones.co.uk

Whilst every effort is made to ensure the accuracy of these details, it should be noted that the measurements are approximate only. Floorplans are for representation purposes only and prepared according to the RICS Code of Measuring Practice by our floorplan provider. Therefore, the layout of doors, windows and rooms are approximate and should be regarded as such by any prospective purchaser. Any internal photographs are intended as a guide only and it should not be assumed that any of the furniture/fittings are included in any sale. Where shown, details of lease, ground rent and service charge are provided by the vendor and their accuracy cannot be guaranteed, as the information may not have been verified and further checks should be made either through your solicitor/conveyance. Where appliances, including central heating, are mentioned, it cannot be assumed that they are in working order, as they have not been tested. Please also note that wiring, plumbing and drains have not been checked.