



Draycott Place, SW3

Draycott Place, SW3

Nestled just off the King's Road, this beautifully presented one-bedroom apartment is finished to an excellent standard throughout and is set on the second floor of an attractive red brick period building.

The generously proportioned reception room features a south-facing bay window, flooding the space with natural light throughout the day and creating a bright, welcoming atmosphere. A separate, well-designed kitchen is fitted with integrated appliances, offering both practicality and a clean, contemporary finish.

The bedroom is quietly positioned to the rear of the property and benefits from ample built-in storage, providing a calm and relaxing retreat. Thoughtfully planned storage solutions throughout the apartment enhance functionality without compromising on style.

Draycott Place is superbly located in the heart of Chelsea, just moments from the King's Road and a short walk from Sloane Square. The area offers an exceptional selection of fashion boutiques, restaurants, cafés, and amenities, while Sloane Square Underground Station provides excellent transport links across the city.

Tenure: Share of Freehold

Modern Design, Prime Location, Sash Windows, Share of Freehold, Well Maintained Building

Asking price: Offers Over £1,000,000

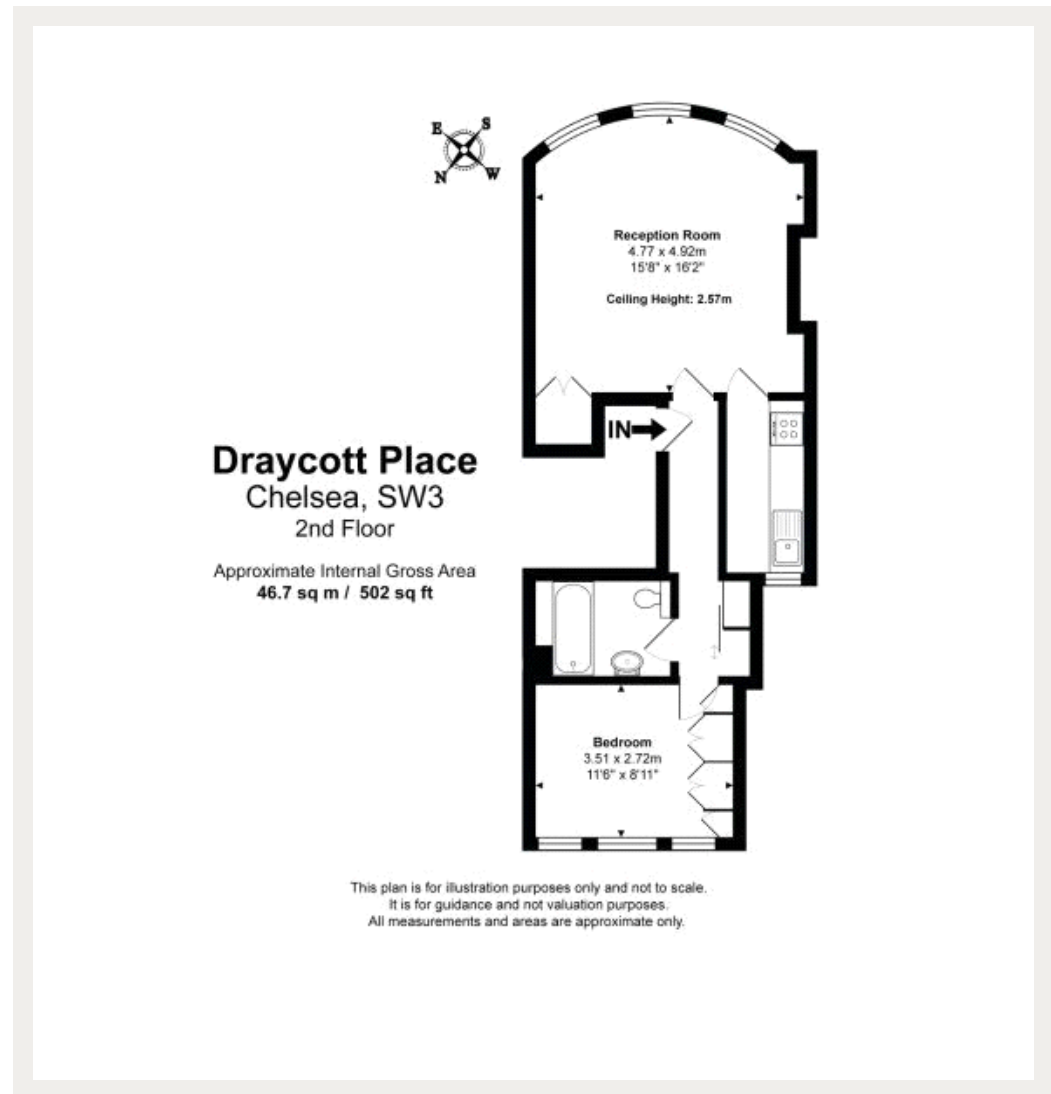
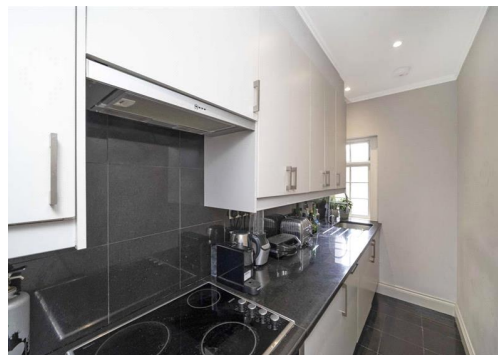

020 7096 9476

contact@landstones.co.uk

Whilst every effort is made to ensure the accuracy of these details, it should be noted that the measurements are approximate only. Floorplans are for representation purposes only and prepared according to the RICS Code of Measuring Practice by our floorplan provider. Therefore, the layout of doors, windows and rooms are approximate and should be regarded as such by any prospective purchaser. Any internal photographs are intended as a guide only and it should not be assumed that any of the furniture/fittings are included in any sale. Where shown, details of lease, ground rent and service charge are provided by the vendor and their accuracy cannot be guaranteed, as the information may not have been verified and further checks should be made either through your solicitor/conveyance. Where appliances, including central heating, are mentioned, it cannot be assumed that they are in working order, as they have not been tested. Please also note that wiring, plumbing and drains have not been checked.